

## ADVANCED ELASTOMER

Load Capacity: 400 to 1,500 lbs.

### Quality Features

- Excellent grease, oil, and chemical resistance.
- Very low rolling resistance.
- High impact strength.
- Will not crack or become brittle or sticky.
- Non-staining.



**Custom compounded urethane elastomer offers the highest abrasion resistance, maximum impact strength, and lowest possible rolling resistance.**

**Withstands nearly all chemicals, greases, oils, solvents and other compounds. Completely solid elastomer means there is absolutely no chance of wheel tread separation caused by bond failure of tread and core.**



**ESD**

Available in Static Dissipative compound (between  $10^5$ - $10^{10}$  Ohms surface resistance) for good protection against electrostatic discharge (ESD).

TEMPERATURE RANGE:  
-50 to +212°F

HARDNESS DUROMETER:  
65 Shore D

COLOR:  
Non-marking gray.



### FLOOR MATERIALS & SURFACE CONDITIONS

Linoleum, Vinyl, Composition	Concrete, Brick, Ceramic Tile	Hardwood, Wood Block, Planking	Asphalt, Rough Surfaces	Carpeted Surfaces	Metal Scraps on Floor	Excessive Heat	Excessive Cold	Harsh Chemicals or Moisture	Electrostatic Discharge
■	■	■	■			■	■	■	■

### Bearing Selection

DELRIN



MACHINED BALL



SEALED PRECISION



CAGED ROLLER



# Access Casters (877) 881-6814

Diameter	Tread Width	Hub Length	Bearing	Bore, w/ Bearing	Bore, less bearing	Load Capacity LBS	Part Number	Series Used In
								
<b>2</b>	<b>7/8</b>	<b>63/64</b>	BALL	3/8	29/32	200	W-32-XAE	30
<b>2½</b>	<b>1¼</b>	<b>1½</b>	BALL	3/8	1-1/8	300	W-62-1/2-XAE	60
<b>3</b>	<b>1¼</b>	<b>1⅙</b>	BALL	3/8	1-1/8	400	W-63-XAE	60, 60SS
			DELRIN	3/8	1-1/8	400	W-63-DAE	
	<b>2</b>	<b>2⅜</b>	BALL	1/2	1-3/16	900	W-83-XAE	80
			DELRIN	1/2	1-3/16	900	W-83-DAE	
			PRECISION BALL	1/2	1-5/8	900	W-83-PXAE	
ROLLER	1/2	1-3/16	900	W-83-TAE				
<b>3½</b>	<b>1¼</b>	<b>1⅙</b>	BALL	3/8		400	W-63 1/2-XAE	60, 60SS
			DELRIN	3/8		400	W-63 1/2-DAE	
<b>4</b>	<b>1¼</b>	<b>1⅙</b>	BALL	3/8	1-3/16	400	W-64-XAE	60, 60SS
			DELRIN	3/8	1-3/16	400	W-64-DAE	
	<b>1⅜</b>	<b>1¼</b>	PRECISION BALL	3/8 - 1/2	1-5/8	600	W-74-PXAE	70
			ROLLER	3/8 - 1/2	1-3/16	600	W-74-TAE	
	<b>2</b>	<b>2⅜</b>	BALL	1/2	1-3/16	1000	W-104-XAE	A100, A100SS
				1/2	1-3/16	1000	W-24-XAE	
				1/2	1-3/16	1000	W-84-XAE	
			DELRIN	1/2	1-3/16	1000	W-104-DAE	A100, A100SS
				1/2	1-3/16	1000	W-24-DAE	
				1/2	1-3/16	1000	W-84-DAE	
			PRECISION BALL	1/2	1-5/8	1000	W-104-PXAE	A100, A100SS
				1/2	1-5/8	1000	W-24-PXAE	
				1/2	1-5/8	1000	W-84-PXAE	
	ROLLER	1/2	1-3/16	1000	W-104-TAE	A100, A100SS		
		1/2	1-3/16	1000	W-24-TAE			
1/2		1-3/16	1000	W-84-TAE				
<b>5</b>	<b>1¼</b>	<b>1⅙</b>	BALL	3/8		400	W-65-XAE	60, 60SS
			DELRIN	3/8		400	W-65-DAE	
	<b>1⅜</b>	<b>1¼</b>	PRECISION BALL	3/8 - 1/2		700	W-75-PXAE	70
			ROLLER	3/8 - 1/2		700	W-75-TAE	
	<b>2</b>	<b>2⅜</b>	BALL	1/2		1000	W-105-XAE	A100, A100SS
				1/2		1000	W-25-XAE	
				1/2		1000	W-85-XAE	
			DELRIN	1/2		1000	W-105-DAE	A100, A100SS
				1/2		1000	W-25-DAE	
				1/2		1000	W-85-DAE	
			PRECISION BALL	1/2		1000	W-105-PXAE	A100, A100SS
				1/2		1000	W-25-PXAE	
				1/2		1000	W-85-PXAE	
	ROLLER	1/2		1000	W-105-TAE	A100, A100SS		
		1/2		1000	W-25-TAE			
1/2			1000	W-85-TAE				
<b>6</b>	<b>1⅜</b>	<b>1¼</b>	PRECISION BALL	3/8 - 1/2	1-5/8	750	W-76-PXAE	70
			ROLLER	3/8 - 1/2	1-3/16	750	W-76-TAE	
	<b>2</b>	<b>2⅜</b>	BALL	1/2	1-3/16	1100	W-106-XAE	A100, A100SS
				1/2	1-3/16	1100	W-26-XAE	
				1/2	1-3/16	1100	W-86-XAE	
			DELRIN	1/2	1-3/16	1100	W-106-DAE	A100, A100SS
				1/2	1-3/16	1100	W-26-DAE	
				1/2	1-3/16	1100	W-86-DAE	
			PRECISION BALL	1/2	1-5/8	1100	W-106-PXAE	A100, A100SS
				1/2	1-5/8	1100	W-26-PXAE	
				1/2	1-5/8	1100	W-86-PXAE	
	ROLLER	1/2	1-3/16	1100	W-106-TAE	A100, A100SS		
		1/2	1-3/16	1100	W-26-TAE			
		1/2	1-3/16	1100	W-86-TAE			
	<b>2½</b>	<b>2¼</b>	PRECISION BALL	3/4	2-7/16	1500	W-606-PXAE	--
<b>8</b>	<b>2</b>	<b>2⅜</b>	BALL	1/2		1200	W-108-XAE	A100, A100SS
				1/2		1200	W-88-XAE	
			DELRIN	1/2		1200	W-108-DAE	A100, A100SS
				1/2		1200	W-88-DAE	
			PRECISION BALL	1/2		1200	W-108-PXAE	A100, A100SS
				1/2		1200	W-88-PXAE	
	ROLLER	1/2		1200	W-108-TAE	A100, A100SS		
		1/2		1200	W-88-TAE			
	<b>2½</b>	<b>2¼</b>	PRECISION BALL	3/4	2-7/16	1650	W-608-PXAE	--
<b>10</b>	<b>2½</b>	<b>2¼</b>	PRECISION BALL	3/4	2-7/16	1800	W-610-PXAE	--



## NEOPRENE RUBBER

Load Capacity: 50 to 670 lbs.

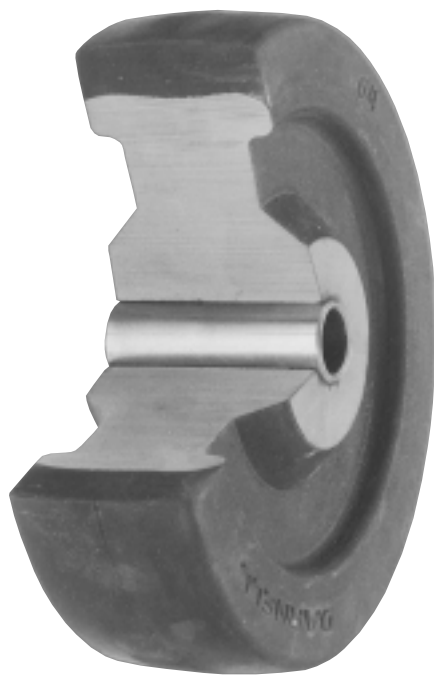

### Quality Features

- Excellent grease, oil, and chemical resistance.
- Withstands weather and ozone exposure.
- Will not crack or become brittle or sticky.
- Non-staining.

**Soft, solid wheel is specially formulated with a premium compound to withstand wear and abrasion while resisting oil, grease, and most chemicals.**

**Soft tread is permanently molded to a hard center core for added strength and higher load capacities. All Neoprene rubber wheels are carefully handcrafted at our factory in City of Industry, California.**



Available in Electrically Conductive (less than 10<sup>9</sup> Ohms surface resistance) for excellent protection against electrostatic discharge (ESD).

TEMPERATURE RANGE:

-20° to +180°F

HARDNESS DUROMETER:

78 Shore A

COLOR:

Non-staining black or non-marking gray.



### FLOOR MATERIALS & SURFACE CONDITIONS

Linoleum, Vinyl, Composition	Concrete, Brick, Ceramic Tile	Hardwood, Wood Block, Planking	Asphalt, Rough Surfaces	Carpeted Surfaces	Metal Scraps on Floor	Excessive Heat	Excessive Cold	Harsh Chemicals or Moisture	Electrostatic Discharge
■	■	■	■				■	■	■

### Bearing Selection

PLAIN ACETAL



MACHINED BALL



ROLLER



TAPERED ROLLER

CUP AND CONE





## NEOPRENE RUBBER

Diameter	Tread Width	Hub Length	Bearing	Bore, w/ Bearing	Bore, less bearing	Load Capacity	Part Number	Series Used In
<b>1 5/8</b>	<b>1 1/16</b>	1 1/16	ACETAL	3/16	—	50	W-1-EZDN	—
		3/4		9/32	—	50	W-2-EZDN	
<b>1 3/4</b>	<b>3/4</b>	7/8	ACETAL	1/4	—	60	W-7-PDN	7
			BALL	1/4	—	60	W-7-XDN	
<b>2</b>	<b>3/4</b>	7/8	ACETAL	5/16	—	80	W-9-PDN	9
			BALL	5/16	—	80	W-9-XDN	
	<b>7/8</b>	6 3/4	BALL	3/8	29/32	90	W-32-XDN	30
			ACETAL	5/16	—	100	W-52-PDN	50, CRV-2.5
BALL	5/16	1-1/8	100	W-52-XDN				
<b>2 1/2</b>	<b>7/8</b>	6 3/4	BALL	3/8	29/32	95	W-32 1/2-XDN	30
	<b>1</b>	1 1/8	ACETAL	—	7/16	110	W-52 1/2-PDN	50
			BALL	1/2	—	200	W-62 1/2-PDN	60, 60SS
BALL	3/8	1-1/8	200	W-62 1/2-XDN	60, 60SS			
<b>3</b>	<b>3/4</b>	7/8	ACETAL	5/16	—	80	W-11-PDN	11
			BALL	5/16	29/32	110	W-53-XDN	30, 50, 50SS, CR II-3
	ACETAL	1/2	—	200	W-63-PDN	60, 60SS		
	BALL	3/8	1-1/8	200	W-63-XDN			
	<b>1 3/8</b>	1 1/2	ACETAL	9/16	—	300	W-73-PDN	70
			BALL	3/8	1-1/8	300	W-73-XDN	
	ROLLER	5/8	1-1/16	300	W-73-TDN	20, 80		
TAPERED ROLLER	19/32	1-3/8	350	W-103-YDN				
<b>3 1/2</b>	<b>1 1/4</b>	1 1/2	ACETAL	1/2	—	200	W-63 1/2-PDN	60, 90, 60SS, 90SS
			BALL	3/8	1-1/8	200	W-63 1/2-XDN	
<b>4</b>	<b>7/8</b>	1 1/8	ACETAL	7/16	—	110	W-54-PDN	30, 50, 50SS
			BALL	5/16	29/32	110	W-54-XDN	
	<b>1 1/4</b>	1 1/2	ACETAL	1/2	—	200	W-64-PDN	60, 90, 60SS, 90SS
			BALL	3/8	1-1/8	200	W-64-XDN	
	<b>1 3/8</b>	1 3/4	ACETAL	9/16	—	300	W-74-PDN	70
ROLLER			5/8	1-1/16	300	W-74-TDN		
<b>1 13/16</b>	2 1/4	ROLLER	5/8	1-3/16	350	W-104-TDN	20, 80	
<b>5</b>	<b>7/8</b>	1 1/8	ACETAL	7/16	—	110	W-55-PDN	30, 50, 50SS
			BALL	5/16	29/32	110	W-55-XDN	
	<b>1 1/4</b>	1 1/2	ACETAL	1/2	—	200	W-65-PDN	60, 90, 60SS, 90SS
			BALL	3/8	1-1/8	200	W-65-XDN	
	<b>1 3/8</b>	1 3/4	ACETAL	9/16	—	300	W-75-PDN	70
			BALL	3/8	1-1/8	300	W-75-XDN	
	ROLLER	5/8	1-1/16	300	W-75-TDN	20, 80, 4L		
<b>1 13/16</b>	2 1/4	ROLLER	5/8	1-3/16	350		W-105-TDN	
<b>2 1/2</b>	2 13/16	ROLLER	3/4	1-7/16	550	W-605-TDN	D600, 4L	
<b>6</b>	<b>1 1/4</b>	1 1/2	ACETAL	1/2	—	220	W-66-PDN	60, 60SS
			BALL	3/8	1-1/8	220	W-66-XDN	
	<b>1 3/8</b>	1 3/4	ACETAL	9/16	—	300	W-76-PDN	70
			ROLLER	5/8	1-1/16	300	W-76-TDN	
	<b>1 13/16</b>	2 1/4	ROLLER	5/8	1-3/16	350	W-106-TDN	80, 4L
TAPERED ROLLER			3/4	1-3/8	350	W-106-YDN		
<b>2 1/2</b>	2 13/16	ROLLER	3/4	1-7/16	550	W-606-TDN	D600, 4L	
<b>8</b>	<b>2</b>	2 1/4	ROLLER	5/8	1-3/16	475	W-88-TDN	80
			ROLLER	3/4	1-7/16	670	W-608-TDN	4L



## HI-CAP NEOPRENE RUBBER

Load Capacity: 60 to 840 lbs.

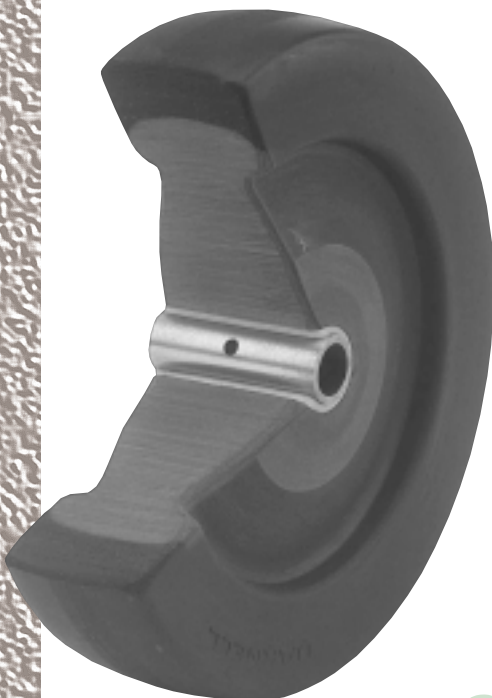

### Quality Features

- Higher load capacity.
- Excellent grease, oil, and chemical resistance.
- Withstands weather and ozone exposure.
- Will not crack or become brittle or sticky.
- Non-staining.

**Our exclusive formula blends corded fibers with specially formulated Neoprene to provide added load capacity in a soft resilient wheel. Withstands wear and abrasion while resisting oil, grease, and most chemicals. Soft tread is permanently molded to a hard center core for added strength and higher load capacities. All Hi-Cap Neoprene rubber wheels are expertly handcrafted at our factory in City of Industry, California.**



Available in Electrically Conductive (less than  $10^5$  Ohms surface resistance) for excellent protection against electrostatic discharge (ESD).

#### TEMPERATURE RANGE:

-20° to +180°F

#### HARDNESS DUROMETER:

90 Shore A

#### COLOR:

Non-staining black or non-marking gray.

110



**BARNELL-ROSE**  
Division of BCI Casters Industries, Inc.

### FLOOR MATERIALS & SURFACE CONDITIONS

Linoleum, Vinyl, Composition	Concrete, Brick, Ceramic Tile	Hardwood, Wood Block, Planking	Asphalt, Rough Surfaces	Carpeted Surfaces	Metal Scraps on Floor	Excessive Heat	Excessive Cold	Harsh Chemicals or Moisture	Electrostatic Discharge
■	■	■	■				■	■	■

### Bearing Selection

PLAIN ACETAL



MACHINED BALL



ROLLER



TAPERED ROLLER CUP AND CONE



## HI-CAP NEOPRENE RUBBER

Diameter	Tread Width	Hub Length	Bearing	Bore, w/ Bearing	Bore, less bearing	Load Capacity LBS	Part Number	Series Used In
<b>1 5/8</b>	1 1/16	3/4	GRAPHITE	9/32	—	60	W-2-EZKN	—
		1 1/16	GRAPHITE	3/16	—	60	W-1-EZKN	
<b>1 3/4</b>	3/4	7/8	ACETAL	1/4	—	75	W-7-PKN	7
			BALL	1/4	—	75	W-7-XKN	
<b>2</b>	3/4	7/8	ACETAL	5/16	—	100	W-9-PKN	9
			BALL	5/16	—	100	W-9-XKN	
	<b>1</b>	1 1/8	BALL	3/8	29/32	110	W-32-XKN	30
			ACETAL	—	—	125	W-51-PKN	50
BALL	—	29/32	125	W-51-XKN				
<b>2 1/2</b>	7/8	6 3/4	BALL	3/8	29/32	120	W-32 1/2-XKN	30
	<b>1</b>	1 1/8	ACETAL	7/16	—	140	W-52 1/2-PKN	50, CRV-2.5
			BALL	5/16	29/32	140	W-52 1/2-XKN	
	<b>1 1/4</b>	1 1/2	ACETAL	1/2	—	250	W-62 1/2-PKN	60, 60SS
BALL			3/8	1-1/8	250	W-62 1/2-XKN		
<b>3</b>	3/4	7/8	ACETAL	5/16	—	100	W-11-PKN	11
	7/8	1 1/8	ACETAL	7/16	—	135	W-53-PKN	30, 50, 50SS, CR II-3
			BALL	5/16	29/32	135	W-53-XKN	
	1 1/4	1 1/2	ACETAL	1/2	—	250	W-63-PKN	60, 60SS
			BALL	3/8	1-1/8	250	W-63-XKN	
	1 3/8	1 1/2	ACETAL	9/16	—	375	W-73-PKN	70
			BALL	3/8	1-1/8	375	W-73-XKN	
	1 7/8	2 1/4	ROLLER	5/8	1-1/16	375	W-73-TKN	20, 80
ROLLER			5/8	1-3/16	440	W-103-TKN		
TAPERED ROLLER	19/32	1-3/8	440	W-103-YKN				
<b>3 1/2</b>	1 1/4	1 1/2	ACETAL	1/2	—	250	W-63 1/2-PKN	60, 90, 60SS, 90SS
			BALL	3/8	1-1/8	250	W-63 1/2-XKN	
<b>4</b>	7/8	1 1/8	ACETAL	7/16	—	135	W-54-PKN	30, 50, 50SS
			BALL	5/16	29/32	135	W-54-XKN	
	1 1/4	1 1/2	ACETAL	1/2	—	250	W-64-PKN	60, 90, 60SS, 90
			BALL	3/8	1-1/8	250	W-64-XKN	
	1 3/8	1 3/4	ACETAL	9/16	—	375	W-74-PKN	70
			ROLLER	5/8	1-1/16	375	W-74-TKN	
1 13/16	2 1/4	ROLLER	5/8	1-3/16	440	W-104-TKN	20, 80, 90	
<b>5</b>	7/8	1 1/8	ACETAL	7/16	—	135	W-55-PKN	30, 50, 50SS
			BALL	5/16	29/32	135	W-55-XKN	
	1 1/4	1 1/2	ACETAL	1/2	—	250	W-65-PKN	60, 90, 60SS, 90SS
			BALL	3/8	1-3/16	250	W-65-XKN	
	1 3/8	1 3/4	ACETAL	9/16	—	375	W-75-PKN	70
			BALL	3/8	1-3/16	375	W-75-XKN	
	ROLLER	5/8	1-1/16	375	W-75-TKN			
	1 13/16	2 1/4	ROLLER	5/8	1-3/16	440	W-105-TKN	20, 80, 4L
2 1/2	2 13/16	ROLLER	3/4	1-7/16	700	W-605-TKN	D600, 4L	
<b>6</b>	1 1/4	1 1/2	ACETAL	1/2	—	275	W-66-PKN	60, 60SS
			BALL	3/8	1-3/16	275	W-66-XKN	
	1 3/8	1 3/4	ACETAL	9/16	—	375	W-76-PKN	70
			ROLLER	5/8	1-1/16	375	W-76-TKN	
	1 13/16	2 1/4	ROLLER	5/8	1-3/16	440	W-106-TKN	80, 4L
			TAPERED ROLLER	3/4	1-3/8	440	W-106-YKN	
2 1/2	2 13/16	ROLLER	—	—	700	W-606-TKN	D600, 4L	
<b>8</b>	2	2 1/4	ROLLER	5/8	1-3/16	600	W-88-TKN	80
	2 1/2	2 13/16	ROLLER	3/4	1-7/16	840	W-608-TKN	4L



## HARD RUBBER

Load Capacity: 50 to 670 lbs.

### Quality Features

- High load capacity.
- Excellent grease, oil, and chemical resistance.
- Withstands impact from shock loading.
- Will not crack or become brittle or sticky.
- Non-staining.

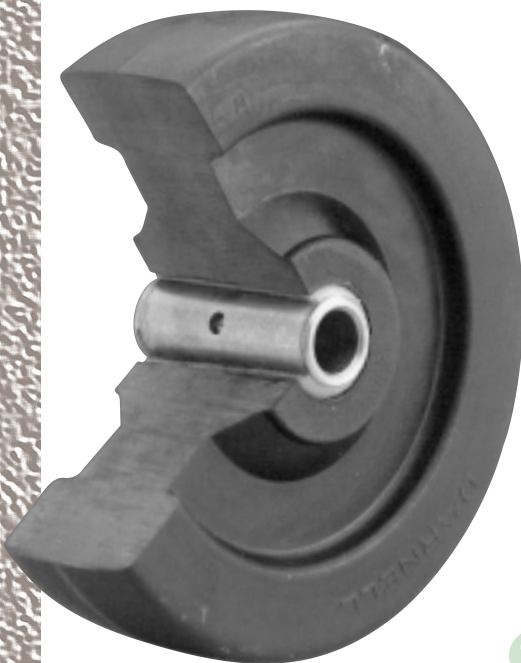

**Tough, solid hard rubber wheels roll easily under heavy loads. Will not chip or crack under impact. Special compound is formulated to resist wear and abrasion. Not affected by oils, grease, water, or cleaning solvents, and will not mark floors. Hard Rubber wheels are expertly handcrafted at our factory in City of Industry, California.**



UNDERWRITERS  
LABORATORY

Available in Electrically Conductive (less than  $10^5$  Ohms surface resistance) for excellent protection against electrostatic discharge (ESD).

TEMPERATURE RANGE:  
-20° to +140°F

HARDNESS DUROMETER:  
80 Shore D

COLOR:  
Non-staining black or non-marking gray.

112



**BARNELL-ROSE**  
Division of Diversified Industries, Inc.

### FLOOR MATERIALS & SURFACE CONDITIONS

Linoleum, Vinyl, Composition	Concrete, Brick, Ceramic Tile	Hardwood, Wood Block, Planking	Asphalt, Rough Surfaces	Carpeted Surfaces	Metal Scraps on Floor	Excessive Heat	Excessive Cold	Harsh Chemicals or Moisture	Electrostatic Discharge
■	■	■	■	■				■	■

### Bearing Selection

PLAIN ACETAL



MACHINED BALL



ROLLER



## HARD RUBBER

Diameter	Tread Width	Hub Length	Bearing	Bore, w/ Bearing	Bore, less bearing	Load Capacity LBS	Part Number	Series Used In
<b>1 5/8</b>	1 1/16	3/4	ACETAL	9/32	—	75	W-2-PH	—
		1 3/16	ACETAL	3/16	—	75	W-1-PH	
<b>1 3/4</b>	3/4	7/8	ROLLER	1/4	5/16	85	W-7-TH	7
<b>2</b>	3/4	7/8	ACETAL	5/16	—	100	W-9-PH	9
			BALL	5/16	29/32	100	W-9-XH	
	<b>1</b>	1 1/8	BALL	3/8	29/32	165	W-32-XH	30
			ACETAL	—	—	150	W-52-PH	50
			BALL	5/16	29/32	150	W-52-XH	
<b>2 1/2</b>	7/8	6 3/4	BALL	3/8	29/32	165	W-32 1/2-XH	30
	<b>1</b>	1 1/8	ACETAL	7/16	—	165	W-52 1/2-PH	50, CRV-2.5
			BALL	5-1/6	—	165	W-52 1/2-XH	50, CR II-3
	<b>1 1/4</b>	1 1/2	ACETAL	1/2	—	400	W-62 1/2-PH	60
BALL			3/8	1-1/8	400	W-62 1/2-XH		
<b>3</b>	3/4	7/8	ACETAL	5/16	—	100	W-11-PH	11
	7/8	1 1/8	ACETAL	7/16	—	165	W-53-PH	30, 50, 50SS, CR II-3
			BALL	5/16	29/32	165	W-53-XH	
	1 1/4	1 1/2	ACETAL	1/2	—	400	W-63-PH	60, 60SS
			BALL	3/8	1-1/8	400	W-63-XH	
	1 3/8	1 3/4	ACETAL	9/16	—	550	W-73-PH	70
			BALL	3/8	1-1/16	550	W-73-XH	
			ROLLER	5/8	1-1/16	550	W-73-TH	
1 7/8	2 1/4	ROLLER	5/8	1-3/16	800	W-83-TH	80	
<b>3 1/2</b>	1 1/4	1 1/2	ACETAL	1/2	—	400	W-63 1/2-PH	60, 90, 60SS, 90SS
			BALL	3/8	1-1/8	400	W-63 1/2-XH	
<b>4</b>	7/8	1 1/8	ACETAL	7/16	—	165	W-54-PH	30, 50, 50SS
			BALL	5/16	29/32	165	W-54-XH	
	1 1/4	1 1/2	ACETAL	1/2	—	400	W-64-PH	60, 90, 60SS, 90SS
	1 3/8	1 3/4	ACETAL	9/16	—	550	W-74-PH	70
ROLLER			5/8	1-1/16	600	W-74-TH		
1 13/16	2 1/4	ROLLER	5/8	1-3/16	800	W-104-TH	20, 80, A100CS	
<b>5</b>	7/8	1 1/8	ACETAL	7/16	—	165	W-55-PH	30, 50, 50SS
			BALL	5/16	29/32	165	W-55-XH	30, 50, 50SS
	1 3/16	2 1/4	ROLLER	5/8	1-3/16	800	W-105-TH	20, 80, A100CS, 4L0
	1 1/4	1 1/2	ACETAL	1/2	—	400	W-65-PH	60, 90, 60SS, 90SS
			BALL	3/8	1-1/8	400	W-65-XH	60
	1 3/8	1 3/4	ACETAL	9/16	—	600	W-75-PH	70
ROLLER			5/8	1-1/16	600	W-75-TH	70	
2 1/2	2 13/16	ROLLER	3/4	1-7/16	1000	W-605-TH	D600, 4LA	
<b>6</b>	1 1/4	1 1/2	ACETAL	1/2	—	400	W-66-PH	60, 60SS
			BALL	3/8	1-1/8	400	W-66-XH	
	1 3/8	1 3/4	ACETAL	9/16	—	600	W-76-PH	70
			ROLLER	5/8	1-1/16	600	W-76-TH	
	1 13/16	2 1/4	ROLLER	5/8	1-3/16	900	W-106-TH	80, 4L0
2 1/2	2 13/16	ROLLER	3/4	1-7/16	1000	W-606-TH	D600, 4LA	
<b>8</b>	2	2 1/4	ROLLER	5/8	1-3/16	900	W-88-TH	80, 4L0
	2 1/2	2 13/16	ROLLER	3/4	1-7/16	1000	W-608-TH	D600, 4LA, 4M



# EXTRA SOFT "E-Z ROLL"

Load Capacity: 80 to 300 lbs.

## Quality Features

- Excellent grease, oil, and chemical resistance.
- Absorbs shock and vibration.
- Great for indoor/outdoor applications.
- Will not crack or become brittle.
- Non-staining.

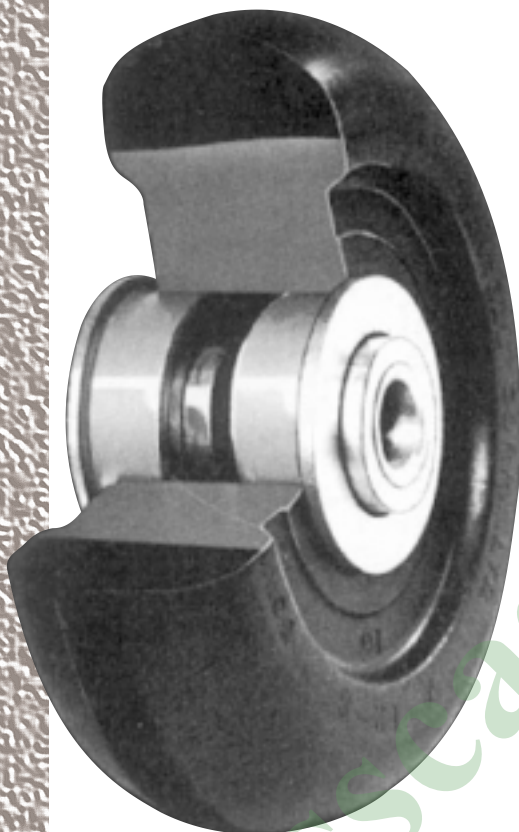

**Extra Soft, solid wheel is extremely resilient and will absorb shock while providing a smooth, quiet ride. Special soft Neoprene compound withstands wear and abrasion while resisting oil, grease, and most chemicals. Hard center core provides increased mobility under heavy loads.**

**The E-Z Roll donut style wheel is ideal for carts or equipment used in offices, stores, hospitals and institutions. The resiliency of the E-Z Roll also makes it the perfect wheel for carpeted surfaces as it reduces carpet roll-up and helps to reduce carpet wear. Use with ball bearings for carpet installations.**

**All Extra Soft E-Z Roll wheels are expertly handcrafted at our factory in City of Industry, California.**



UNDERWRITERS  
LABORATORY

Available in Electrically Conductive (less than 10<sup>5</sup> Ohms surface resistance) for excellent protection against electrostatic discharge (ESD).



**TEMPERATURE RANGE:**  
-20° to +180°F

**HARDNESS DUROMETER:**  
60 Shore A

**COLOR:**  
Non-staining black or non-marking gray. Gray not available in Extra Soft

### Bearing Selection

PLAIN ACETAL

MACHINED BALL





EXTRA SOFT  
"E-Z ROLL"

FLOOR MATERIALS & SURFACE CONDITIONS

Linoleum, Vinyl, Composition	Concrete, Brick, Ceramic Tile	Hardwood, Wood Block, Planking	Asphalt, Rough Surfaces	Carpeted Surfaces	Metal Scraps on Floor	Excessive Heat	Excessive Cold	Harsh Chemicals or Moisture	Electrostatic Discharge
■	■	■	■	■	■			■	■



EXTRA SOFT NEOPRENE "E-Z ROLL"

Diameter	Tread Width	Hub Length	Bearing	Bore, w/ Bearing	Bore, less bearing	Load Capacity	Part Number	Series Used In
3	15/16	1 1/8	ACETAL	7/16	-	100	W-53-PEZN-RD	30, 50, 50SS, CR II-3
	1 1/4	1 1/2	BALL	5/16	29/32	100	W-53-XEZN-RD	
4	15/16	1 1/8	ACETAL	7/16	-	100	W-54-PEZN-RD	30, 50, 50SS
	1 1/4	1 1/2	BALL	5/16	29/32	100	W-54-XEZN-RD	
5	15/16	1 1/8	ACETAL	7/16	-	100	W-55-PEZN-RD	30, 50, 50SS
	1 1/4	1 1/2	BALL	5/16	29/32	100	W-55-XEZN-RD	
5 1/2	1 5/8	1 15/16	ACETAL	1/2	-	200	W-65-PEZN-RD	60, 90, 60SS, 90SS
	1 3/8	1 3/4	BALL	3/8	1-1/8	200	W-65-XEZN-RD	
6	1 1/4	1 1/2	ACETAL	7/16	-	100	W-64-PEZN-RD	60, 90, 60SS, 90SS
8	1 9/16	1 15/32	ACETAL	1/2	-	200	W-66-PEZN-RD	60, 90, 60SS, 90SS
8	1 9/16	1 15/32	ACETAL	3/8	1-1/8	200	W-68-PEZN-RD	60, 90, 60SS, 90SS
			BALL	3/8	1-1/8	200	W-68-XEZN-RD	

ROUND DONUT "E-Z ROLL"

Diameter	Tread Width	Hub Length	Bearing	Bore, w/ Bearing	Bore, less bearing	Load Capacity	Part Number	Series Used In
2	3/4	7/8	ACETAL	5/16	-	80	W-9-PDN-RD	9
	7/8	63/64	BALL	3/8	29/32	150	W-32-XDN-RD	30
3	1	1 1/8	ACETAL	5/16	-	100	W-52-PDN-RD	50
	7/8	1 1/8	ACETAL	7/16	-	100	W-53-PDN-RD	50
3	1 1/4	1 1/2	ACETAL	1/2	-	200	W-63-PDN-RD	60
			BALL	3/8	1-1/8	200	W-63-XDN-RD	
4	7/8	1 1/8	ACETAL	7/16	-	100	W-54-PDN-RD	50
			BALL	5/16	29/32	100	W-54-XDN-RD	
4	1 1/4	1 1/2	ACETAL	1/2	-	200	W-64-PDN-RD	60
			BALL	3/8	1-1/8	200	W-64-XDN-RD	
5	7/8	1 1/8	ACETAL	7/16	-	100	W-55-PDN-RD	50
			BALL	5/16	29/32	100	W-55-XDN-RD	
5	1 3/8	1 3/4	ACETAL	9/16	-	300	W-75-PDN-RD	70



Load Capacity: 500 to 900 lbs.

## MOLD-ON NEOPRENE

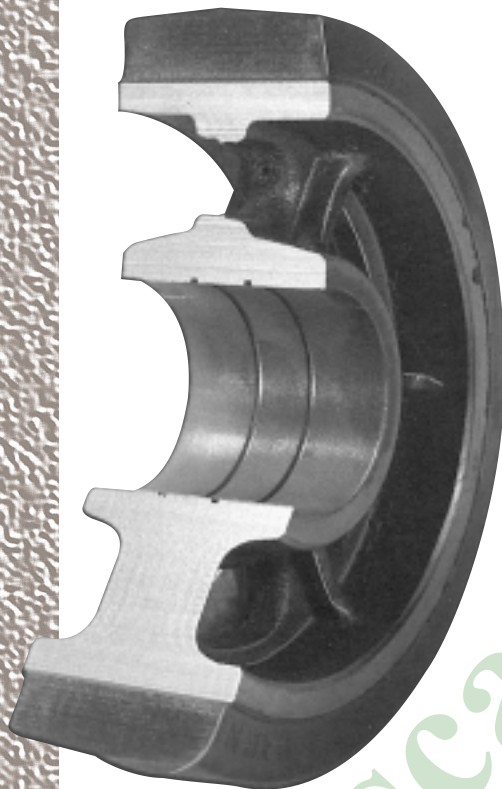

### Quality Features

- Excellent grease, oil, and chemical resistance.
- Quiet operation.
- Good floor protection.
- Withstands weather and ozone exposure.
- Will not crack or become brittle or sticky.

## MOLD-ON HI-CAP NEOPRENE

### Cast Iron Hub

**Mold-on Neoprene is permanently bonded to a machined cast iron core to provide the highest load capacity and best floor protection. They are quiet in operation, absorb shock, prolong equipment life and protect cargo. Hi-cap formula blends corded fibers with specially formulated Neoprene to provide added load capacity in a soft, resilient wheel. Withstands wear and abrasion while resisting oil, grease, and most chemicals. All mold-on Neoprene wheels are expertly handcrafted at our factory in City of Industry, California.**

116



**BARNELL-ROSE**  
Division of Diversified Industries, Inc.



Available in Electrically Conductive (less than  $10^5$  Ohms surface resistance) for excellent protection against electrostatic discharge (ESD).

Bearing Selection

ROLLER



TAPERED ROLLER CUP AND CONE





## SPECIFICATIONS

**TEMPERATURE RANGE:**  
Standard: -35° to +220°F  
Hi-Cap: -30° to +195°F

**HARDNESS DUROMETER:**  
Standard: 73-80 Shore A  
Hi-Cap: 85-92 Shore A

**COLOR:**  
Non-staining black or  
non-marking gray.

## FLOOR MATERIALS & SURFACE CONDITIONS

Linoleum, Vinyl, Composition	Concrete, Brick, Ceramic Tile	Hardwood, Wood Block, Planking	Asphalt, Rough Surfaces	Carpeted Surfaces	Metal Scraps on Floor	Excessive Heat	Excessive Cold	Harsh Chemicals or Moisture	Electrostatic Discharge
■	■	■	■			■	■	■	■



## MOLD-ON NEOPRENE

Diameter	Tread Width	Hub Length	Bearing	Bore, w/ Bearing	Bore, less bearing	Load Capacity	Part Number	Series Used In
<b>6</b>	<b>2½</b>	<b>2⅜</b>	TAPERED ROLLER	3/4	1-5/8	550	W-606-YDN-M-CI	D600
	<b>2¾</b>	<b>¾</b>	ROLLER	1-1/4	2-1/16	600	W-4006-TDN-M-CI	4500, 5200
			TAPERED ROLLER	1-1/4	2-21/64	600	W-4006-YDN-M-CI	
<b>8</b>	<b>2½</b>	<b>2⅜</b>	TAPERED ROLLER	3/4	1-5/8	550	W-608-YDN-M-CI	D600
	<b>2¾</b>	<b>¾</b>	ROLLER	1-1/4	2-1/16	600	W-4008-TDN-M-CI	4500, 5200
			TAPERED ROLLER	1-1/4	2-21/64	600	W-4008-YDN-M-CI	
<b>10</b>	<b>2¾</b>	<b>¾</b>	ROLLER	1-1/4	2-1/16	600	W-4010-TDN-M-CI	4500, 5200
			TAPERED ROLLER	1-1/4	2-21/64	600	W-4010-YDN-M-CI	
<b>12</b>	<b>2¾</b>	<b>¾</b>	ROLLER	1-1/4	2-1/16	700	W-4012-TDN-M-CI	4500, 5200
			TAPERED ROLLER	1-1/4	2-21/64	700	W-4012-YDN-M-CI	

## MOLD-ON HI-CAP NEOPRENE

Diameter	Tread Width	Hub Length	Bearing	Bore, w/ Bearing	Bore, less bearing	Load Capacity	Part Number	Series Used In
<b>6</b>	<b>2½</b>	<b>2⅜</b>	TAPERED ROLLER	3/4	1-5/8	670	W-606-YKN-M-CI	D600
	<b>2¾</b>	<b>¾</b>	ROLLER	1-1/4	2-1/16	750	W-4006-TKN-M-CI	4500, 5200
			TAPERED ROLLER	1-1/4	2-21/64	750	W-4006-YKN-M-CI	
<b>8</b>	<b>2½</b>	<b>2⅜</b>	TAPERED ROLLER	3/4	1-5/8	670	W-608-YKN-M-CI	D600
	<b>2¾</b>	<b>¾</b>	ROLLER	1-1/4	2-1/16	750	W-4008-TKN-M-CI	4500, 5200
			TAPERED ROLLER	1-1/4	2-21/64	750	W-4008-YKN-M-CI	
<b>10</b>	<b>2¾</b>	<b>¾</b>	ROLLER	1-1/4	2-1/16	750	W-4010-TKN-M-CI	4500, 5200
			TAPERED ROLLER	1-1/4	2-21/64	750	W-4010-YKN-M-CI	
<b>12</b>	<b>2¾</b>	<b>¾</b>	ROLLER	1-1/4	2-1/16	900	W-4012-TKN-M-CI	4500, 5200
			TAPERED ROLLER	1-1/4	2-21/64	900	W-4012-YKN-M-CI	



## STEEL DISC NEOPRENE

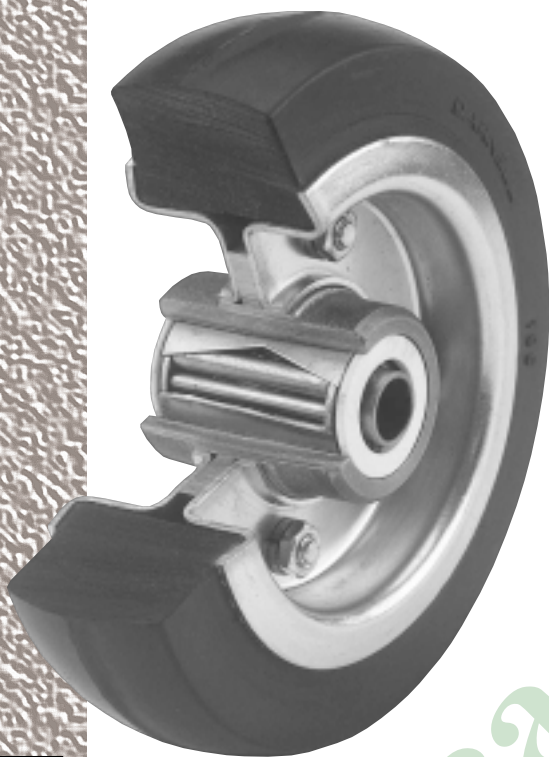

Load Capacity: 200 to 550 lbs.

### Quality Features

- Excellent grease, oil, and chemical resistance.
- Worn tires can be replaced.
- Quiet operation.
- Good floor protection.
- Withstands weather and ozone exposure.

**Demountable Neoprene tire is held firmly in place between two Bright zinc plated steel discs which are securely bolted together. Bearings are mounted to provide quiet operation and smooth effortless ride. These wheels roll well on carpeted floors and are ideal for wheeled hospital and institutional equipment. Hi-Cap formula blends corded fibers with specially formulated Neoprene to provide added load capacity in a soft resilient wheel. Withstands wear and abrasion while resisting oil, grease and most chemicals. All Steel-Disc Neoprene wheels are expertly handcrafted at our factory in City of Industry, California.**

## STEEL DISC HI-CAP NEOPRENE



Available in Electrically Conductive (less than 10<sup>5</sup> Ohms surface resistance) for excellent protection against electrostatic discharge (ESD).

#### TEMPERATURE RANGE:

Standard: -35° to +220°F  
Hi-Cap: -30° to +195°F

#### HARDNESS DUROMETER:

Standard: 73-80 Shore A  
Hi-Cap: 85-92 Shore A

#### COLOR:

Non-staining black or non-marking gray.



### FLOOR MATERIALS & SURFACE CONDITIONS

Linoleum, Vinyl, Composition	Concrete, Brick, Ceramic Tile	Hardwood, Wood Block, Planking	Asphalt, Rough Surfaces	Carpeted Surfaces	Metal Scraps on Floor	Excessive Heat	Excessive Cold	Harsh Chemicals or Moisture	Electrostatic Discharge
■	■	■		■	■		■	■	■

### Bearing Selection









#### MACHINED BALL

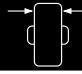

#### ROLLER





## STEEL DISC NEOPRENE

Diameter	Tread Width	Hub Length	Bearing	Bore, w/ Bearing	Bore, less bearing	Load Capacity LBS	Part Number	Series Used In
								
<b>3 1/2</b>	<b>1</b>	<b>1 1/2</b>	BALL	3/8	—	200	W-63 1/2-XDN-T-SD	60
<b>4</b>	<b>1 1/4</b>	<b>1 1/2</b>	BALL	3/8	—	200	W-64-XDN-T-SD	60
		<b>1 3/4</b>		3/8	—	300	W-74-XDN-T-SD	70
<b>5</b>	<b>1 1/4</b>	<b>1 1/2</b>	BALL	3/8	—	200	W-65-XDN-T-SD	60
	<b>1 5/16</b>	<b>1 3/4</b>		3/8	—	300	W-75-XDN-T-SD	70
	<b>1 9/16</b>	<b>2 1/4</b>	ROLLER	5/8	1-3/16	350	W-105-TDN-T-SD	80, 4LO
	<b>2 3/16</b>	<b>2 13/16</b>		3/4	1-3/16	550	W-605-TDN-T-SD	D600
<b>6</b>	<b>1 1/4</b>	<b>1 1/2</b>	BALL	3/8	—	200	W-66-XDN-T-SD	60
	<b>1 9/16</b>	<b>2 1/4</b>	ROLLER	5/8	1-3/16	350	W-106-TDN-T-SD	80, 4LO
	<b>2 3/16</b>	<b>2 13/16</b>		3/4	1-3/16	550	W-606-TDN-T-SD	D600, 4LA
<b>8</b>	<b>1 3/16</b>	<b>2 1/4</b>	BALL	5/8	—	350	W-1008-XDN-T-SD*	4LA
	<b>1 3/4</b>	<b>2 1/4</b>	ROLLER*	1-1/4	2-1/16	450	W-1A08-TBDN-T-SD	4LA, D600
		<b>2 13/16</b>	ROLLER	3/4	1-7/16	450	W-1A08-TDN-T-SD	
<b>10</b>	<b>1 3/8</b>	<b>2 1/2</b>	BALL	5/8	—	350	W-1010-XDN-T-SD*	—
		<b>2 3/4</b>	ROLLER*	1-1/4	2-1/16	400	W-1A10-TBDN-T-SD	—
<b>12</b>	<b>2</b>	<b>2 3/4</b>	ROLLER*	1-1/4	2-1/16	400	W-1A12-TBDN-T-SD	—

\* 8" and 10" wheel available with rounded tread

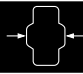
## STEEL DISC HI-CAP NEOPRENE

Diameter	Tread Width	Hub Length	Bearing	Bore, w/ Bearing	Bore, less bearing	Load Capacity LBS	Part Number	Series Used In
								
<b>3 1/2</b>	<b>1</b>	<b>1 1/2</b>	BALL	3/8	—	200	W-63 1/2-XKN-T-SD	60
<b>4</b>	<b>1 1/4</b>	<b>1 1/2</b>	BALL	3/8	—	200	W-64-XKN-T-SD	60
		<b>1 3/4</b>		3/8	—	300	W-74-XKN-T-SD	70
<b>5</b>	<b>1 1/4</b>	<b>1 1/2</b>	BALL	3/8	—	200	W-65-XKN-T-SD	60
	<b>1 5/16</b>	<b>1 3/4</b>		3/8	—	300	W-75-XKN-T-SD	70
	<b>1 9/16</b>	<b>2 1/4</b>	ROLLER	5/8	1-3/16	350	W-105-TKN-T-SD	20, 80, 4LO
	<b>2 3/16</b>	<b>2 13/16</b>		3/4	1-3/16	550	W-605-TKN-T-SD	D600
<b>6</b>	<b>1 1/4</b>	<b>1 1/2</b>	BALL	3/8	—	200	W-66-XKN-T-SD	60
	<b>1 9/16</b>	<b>2 1/4</b>	ROLLER	5/8	1-3/16	350	W-106-TKN-T-SD	80, 4LO
	<b>2 3/16</b>	<b>2 13/16</b>		3/4	1-3/16	550	W-606-TKN-T-SD	D600, 4LA
<b>8</b>	<b>1 3/16</b>	<b>2 1/4</b>	BALL	5/8	—	350	W-1008-XKN-T-SD*	4LA
	<b>1 3/4</b>	<b>2 13/16</b>	ROLLER	3/4	1-7/16	450	W-1A08-TKN-T-SD	4LA, D600
		<b>2 3/4</b>	ROLLER*	1-1/4	2-1/16	450	W-1A08-TBKN-T-SD	
<b>10</b>	<b>1 3/8</b>	<b>2 1/2</b>	BALL	5/8	—	350	W-1010-XKN-T-SD*	—
		<b>2 3/4</b>	ROLLER*	1-1/4	2-1/16	400	W-1A10-TBKN-T-SD	—
<b>12</b>	<b>2</b>	<b>2 3/4</b>	ROLLER*	1-1/4	2-1/16	400	W-1A12-TBKN-T-SD	—

\* available with rounded tread



WHEELS

## MOLD-ON RUBBER Cast Iron Hub

Load Capacity: 150 to 1800 lbs.

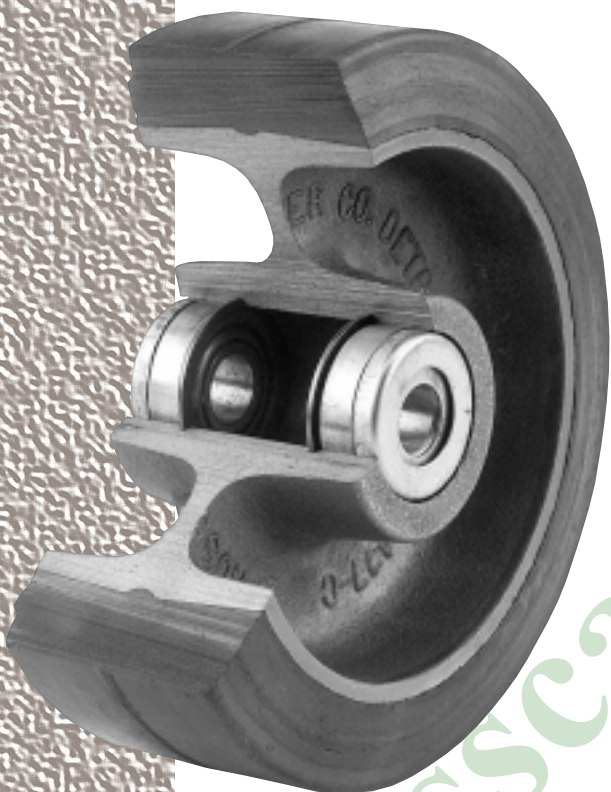

### Quality Features

- Quiet operation.
- Good floor protection.
- Shock absorbing.
- Will not crack or become brittle or sticky.

*Mold-on rubber treads are made of thick, natural, industrial grade rubber that is permanently bonded to a high-strength cast iron core. These ever-popular wheels are quiet and long wearing. Ideal for a multitude of industrial uses. All mold-on rubber wheels are expertly handcrafted at our factory in Detroit, Michigan.*

TEMPERATURE RANGE:

-40° to +200°F

HARDNESS DUROMETER:

70 Shore A

COLOR:

Non-staining black tread / natural core

120



**BARNELL-ROSE**  
Division of Bostwick Industries, Inc.

### FLOOR MATERIALS & SURFACE CONDITIONS

Linoleum, Vinyl, Composition	Concrete, Brick, Ceramic Tile	Hardwood, Wood Block, Planking	Asphalt, Rough Surfaces	Carpeted Surfaces	Metal Scraps on Floor	Excessive Heat	Excessive Cold	Harsh Chemicals or Moisture	Electrostatic Discharge
■	■	■	■				■		

Bearing Selection

ROLLER



TAPERED

CUP AND CONE





# MOLD-ON RUBBER

## Cast Iron Hub

Diameter	Tread Width	Hub Length	Bearing	Bore, w/ Bearing	Bore, less bearing	Load Capacity LBS	Part Number	Series Used In		
										
<b>4</b>	<b>2</b>	<b>2¼</b>	ROLLER	3/4	1-3/16	300	342-RS	A100CS, 400, R600		
<b>5</b>	<b>2</b>	<b>2¼</b>	ROLLER	3/4	1-3/16	350	352-RS	A100CS, 400, R600		
<b>6</b>	<b>2</b>	<b>2¼</b>	ROLLER	3/4	1-3/16	410	362-RS	A100CS, 400, R600		
		<b>2½</b>		1	1-3/4	410	665-RS	R600		
	<b>2½</b>	<b>2¾</b>	ROLLER	1	1-9/16	540	669-RS			
			TAPERED ROLLER	3/4	1-25/32	540	100-6-RS	R100, 650		
			ROLLER	1	1-9/16	680	551-6-RS	550		
<b>8</b>	<b>2</b>	<b>2¼</b>	TAPERED ROLLER	3/4	1-25/32	500	382-RS	A100CS, 400		
			ROLLER	1	1-9/16	670	504-8-RS	500		
	<b>2½</b>	<b>2¾</b>	TAPERED ROLLER	3/4	1-25/32	670	655-8-RS	650		
			ROLLER	1	1-13/16	840	554-8-RS	550, 800		
			ROLLER	1	1-13/16	840	887-RS	800		
	<b>3</b>	<b>3¾</b>	TAPERED ROLLER	3/4	1-25/32	840	100-7-RS	R100, R110		
			TAPERED ROLLER	3/4	1-25/32	840	100-8-RS			
<b>10</b>			<b>2</b>	<b>2¼</b>	ROLLER	3/4	1-13/16	650	4102-RS	400, R600
					ROLLER	1	1-9/16	790	507-10-RS	500
	<b>2½</b>	<b>2¾</b>	TAPERED ROLLER	3/4	1-25/32	790	656-10-RS	650		
			ROLLER	1	1-13/16	1000	557-10-RS	550, 800		
				1	1-13/16	1000	8139-RS	800		
<b>3</b>	<b>3¾</b>	<b>3¾</b>	TAPERED ROLLER	1-3/4	1-25/32	1000	100-10-RS	R100, R110		
				1-3/4	2-7/16	1000	120-10-RS	R120		
			3/4	1-25/32	1000	100-9-RS	R100, R110			
			TAPERED ROLLER	1-3/4	2-7/16	1400	110-104-RS	R110, R120		
<b>11</b>	<b>5</b>	<b>5¼</b>	TAPERED ROLLER	1-3/4	2-7/16	1800	127-11-RS	R120		
<b>12</b>	<b>3</b>	<b>3¾</b>	TAPERED ROLLER	1-3/4	2-21/64	1140	100-12-RS	R100, R110		
	<b>4</b>	<b>4¼</b>	TAPERED ROLLER	1-3/4	2-7/16	1600	130-12-RS	R120		

Members of:







**THERMOPLASTIC RUBBER**  
**Polyolefin Core**

Load Capacity: 150 to 450 lbs.

Quality Features

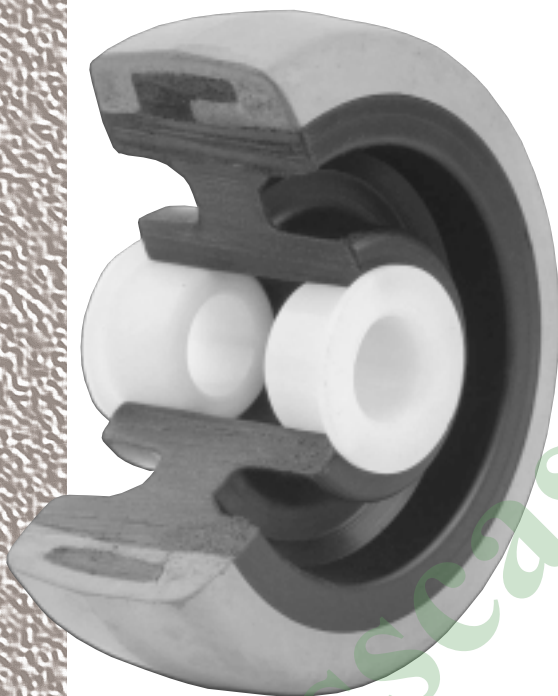
- Excellent floor protection.
- Good grease, oil, and chemical resistance.
- High impact strength.
- Non-staining.
- Will not crack or become brittle or sticky.



**Soft thermoplastic rubber tread is molded to high strength Polypropylene core to offer good floor protection at an economical price. Tread and core are mechanically bonded to prevent separation. Gray tread is non-marking, non-staining, and will not crack or become brittle. An excellent choice for general duty applications where a soft quiet wheel is required.**

TEMPERATURE RANGE:  
-45° to +180°F

HARDNESS DUROMETER:  
80 Shore A

COLOR:  
Non-marking gray.



**FLOOR MATERIALS & SURFACE CONDITIONS**

Linoleum, Vinyl, Composition	Concrete, Brick, Ceramic Tile	Hardwood, Wood Block, Planking	Asphalt, Rough Surfaces	Carpeted Surfaces	Metal Scraps on Floor	Excessive Heat	Excessive Cold	Harsh Chemicals or Moisture	Electrostatic Discharge
■	■	■	■					■	■

*Bearing Selection*

DELTRIN



MACHINED BALL



ROLLER





# THERMOPLASTIC RUBBER

Diameter	Tread Width	Hub Length	Bearing	Bore, w/ Bearing	Bore, less bearing	Load Capacity LBS	Part Number	Series Used In	
<b>2½</b>	<b>1¾</b>	<b>1½</b>	DELRIN	1/2	1-1/8	200	W-62 1/2-DPD-M-PO	60, 60SS	
		<b>1⅝</b>	BALL	3/8	1-1/8	200	W-62 1/2-XPD-M-PO	60	
<b>3</b>	<b>1</b>	<b>1⅜</b>	BALL	5/16	7/8	150	W-53-XPD-M-PO	50	
			PLAIN	5/16	5/16	150	W-53-BPD-M-PO	50, 50SS	
	<b>1⅜</b>	<b>1½</b>	DELRIN	1/2	1-1/8	225	W-63-DPD-M-PO	60, 60SS	
		<b>1⅝</b>	BALL	3/8	1-1/8	225	W-63-XPD-M-PO	60	
<b>3½</b>	<b>1⅜</b>	<b>1½</b>	DELRIN	1/2	1-1/8	240	W-63 1/2-DPD-M-PO	60, 90, 60SS, 90SS	
		<b>1⅝</b>	BALL	3/8	1-1/8	240	W-63 1/2-XPD-M-PO	60, 90	
<b>4</b>	<b>1</b>	<b>1⅜</b>	BALL	5/16	7/8	160	W-54-XPD-M-PO	50	
			PLAIN	5/16	5/16	160	W-54-BPD-M-PO	50, 50SS	
	<b>1⅜</b>	<b>1½</b>	BALL	3/8	1-1/8	250	W-64-XPD-M-PO	60, 90	
			DELRIN	1/2	1-1/8	250	W-64-DPD-M-PO	60, 90, 60SS, 90SS	
	<b>1½</b>	<b>1⅝</b>	ROLLER	5/8	1-3/16	260	W-74-TPD-M-PO	70	
			DELRIN	3/4	1-3/16	300	W-84-DPD-M-PO	20, 80	
	<b>2</b>	<b>2⅜</b>	ROLLER	5/8	1-3/16	300	W-84-TPD-M-PO	20, 80	
			DELRIN	3/4	1-3/16	300	W-104-TPD-M-PO	A100CS, A100SS	
<b>5</b>	<b>1</b>	<b>1⅜</b>	BALL	5/16	7/8	170	W-55-XPD-M-PO	50	
			PLAIN	5/16	5/16	170	W-55-BPD-M-PO	50, 50SS	
	<b>1⅜</b>	<b>1½</b>	DELRIN	1/2	1-1/8	275	W-65-DPD-M-PO	60, 90, 60SS, 90SS	
			BALL	3/8	1-1/8	275	W-65-XPD-M-PO	60, 90	
	<b>1½</b>	<b>1⅝</b>	DELRIN	1/2	1-1/8	320	W-75-DPD-M-PO	70	
			ROLLER	5/8	1-3/16	260	W-74-DPD-M-PO		
	<b>1½</b>	<b>1⅝</b>	ROLLER	5/8	1-3/16	320	W-75-TPD-M-PO	20, 80	
			DELRIN	3/4	1-3/16	350	W-85-DPD-M-PO		
	<b>2</b>	<b>2⅜</b>	ROLLER	5/8	1-3/16	350	W-85-TPD-M-PO	A100CS, A100SS	
			DELRIN	3/4	1-3/16	350	W-105-TPD-M-PO		
	<b>6</b>	<b>1⅜</b>	<b>1½</b>	DELRIN	1/2	1-1/8	300	W-66-DPD-M-PO	60, 60SS
				BALL	3/8	1-1/8	300	W-66-XPD-M-PO	60
<b>1½</b>		<b>1⅝</b>	DELRIN	1/2	1-1/8	350	W-76-DPD-M-PO	70	
			ROLLER	5/8	1-3/16	375	W-76-TPD-M-PO		
<b>2</b>		<b>2⅜</b>	DELRIN	3/4	1-3/16	400	W-86-DPD-M-PO	80	
			ROLLER	5/8	1-3/16	400	W-86-TPD-M-PO		
<b>2</b>		<b>2⅜</b>	DELRIN	3/4	1-3/16	400	W-106-TPD-M-PO	A100CS, A100SS	
			DELRIN	3/4	1-3/16	400	W-106-DPD-M-PO		
<b>8</b>	<b>2</b>	<b>2⅜</b>	DELRIN	3/4	1-3/16	450	W-88-DPD-M-PO	80	
			ROLLER	5/8	1-3/16	450	W-88-TPD-M-PO		
		<b>2⅝</b>	ROLLER	3/4	1-3/16	450	W-108-TPD-M-PO	A100CS, A100SS	
			DELRIN	3/4	1-3/16	450	W-108-DPD-M-PO		

Members of:

NSF  
NATIONAL SANITATION FOUNDATION

MATERIAL HANDLING INDUSTRY OF AMERICA®

Inflight  
Food Service Association

WORLDWIDE D-I-Y COUNCIL

icm  
INSTITUTE OF CASTER MANUFACTURERS

UL  
UNDERWRITERS LABORATORY

INDUSTRY MANUFACTURERS COUNCIL

nafem





**EXTRA-SOFT  
THERMOPLASTIC  
RUBBER**  
*Polyolefin Core*

Load Capacity: 100 to 300 lbs.

**Quality Features**

- Absorbs shock and vibration.
- Good grease, oil, and chemical resistance.
- Excellent floor protection.
- Will not crack or become brittle or sticky.
- Non-marking.

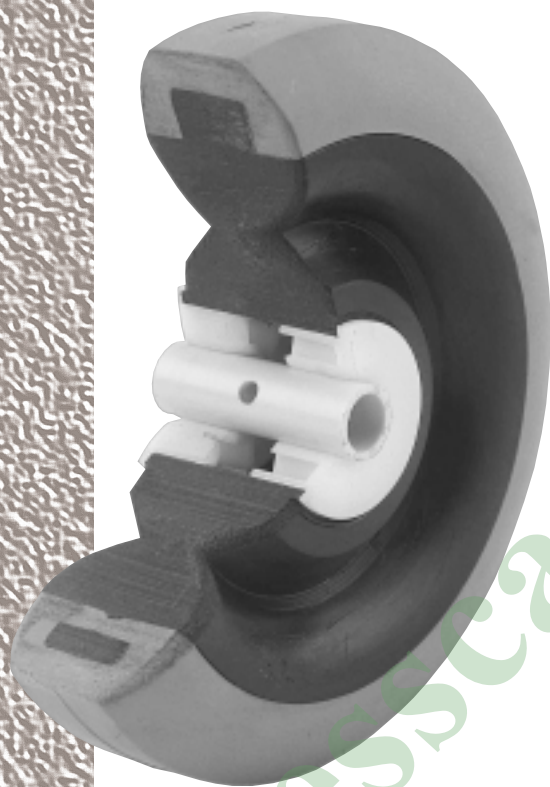

**Extra-soft (55A) thermoplastic rubber tread is extremely resilient, economical, and will absorb shock while providing a smooth, quiet ride. Tread and core are mechanically bonded to prevent separation. Gray tread is non-marking, non-staining, and will not crack or become brittle.**

TEMPERATURE RANGE:

-45° to +180°F

HARDNESS DUROMETER:

55 Shore A

COLOR:

Non-marking gray.



**FLOOR MATERIALS & SURFACE CONDITIONS**

Linoleum, Vinyl, Composition	Concrete, Brick, Ceramic Tile	Hardwood, Wood Block, Planking	Asphalt, Rough Surfaces	Carpeted Surfaces	Metal Scraps on Floor	Excessive Heat	Excessive Cold	Harsh Chemicals or Moisture	Electrostatic Discharge
■	■	■	■	■	■			■	

*Bearing Selection*

DELRIN



MACHINED BALL



ROLLER





# EXTRA-SOFT THERMOPLASTIC RUBBER

Diameter	Tread Width	Hub Length	Bearing	Bore, w/ Bearing	Bore, less bearing	Load Capacity	Part Number	Series Used In
<b>2½</b>	<b>1⅜</b>	<b>1½</b>	DELRIN	1/2	1-1/8	125	W-62 1/2-DPD-M-PO-55	60, 60SS
		<b>1⅝</b>	BALL	3/8	1-1/8	125	W-62 1/2-XPD-M-PO-55	60
<b>3</b>	<b>1</b>	<b>1⅙</b>	BALL	5/16	7/8	100	W-53-XPD-M-PO-55	50
		<b>1⅙</b>	PLAIN	5/16	5/16	100	W-53-BPD-M-PO-55	50, 50SS
	<b>1⅜</b>	<b>1½</b>	DELRIN	1/2	1-1/8	150	W-63-DPD-M-PO-55	60, 60SS
		<b>1⅝</b>	BALL	3/8	1-1/8	150	W-63-XPD-M-PO-55	60
<b>3½</b>	<b>1⅜</b>	<b>1½</b>	DELRIN	1/2	1-1/8	160	W-63 1/2-DPD-M-PO-55	60, 90, 60SS, 90SS
		<b>1⅝</b>	BALL	3/8	1-1/8	160	W-63 1/2-XPD-M-PO-55	60, 90
<b>4</b>	<b>1</b>	<b>1⅙</b>	BALL	5/16	7/8	110	W-54-XPD-M-PO-55	50
		<b>1⅙</b>	PLAIN	5/16	5/16	110	W-54-BPD-M-PO-55	50, 50SS
	<b>1⅜</b>	<b>1½</b>	DELRIN	1/2	1-1/8	170	W-64-DPD-M-PO-55	60, 90, 60SS, 90SS
		<b>1⅝</b>	BALL	3/8	1-1/8	170	W-64-XPD-M-PO-55	60, 90
	<b>1½</b>	<b>1⅝</b>	DELRIN	5/8	1-3/16	185	W-74-DPD-M-PO-55	70
			ROLLER	5/8	1-3/16	185	W-74-TPD-M-PO-55	
	<b>2</b>	<b>2⅙</b>	DELRIN	3/4	1-3/16	200	W-84-DPD-M-PO-55	20, 80
			ROLLER	3/4	1-3/16	200	W-104-TPD-M-PO-55	A100CS, A100SS
<b>2⅝</b>		DELRIN	3/4	1-3/16	200	W-84-TPD-M-PO-55	20, 80	
		DELRIN	3/4	1-3/16	200	W-104-DPD-M-PO-55	A100CS, A100SS	
<b>5</b>	<b>1</b>	<b>1⅙</b>	BALL	5/16	7/8	120	W-55-XPD-M-PO-55	50
		<b>1⅙</b>	PLAIN	5/16	5/16	120	W-55-BPD-M-PO-55	50, 50SS
	<b>1⅜</b>	<b>1½</b>	DELRIN	1/2	1-1/8	180	W-65-DPD-M-PO-55	60, 90, 60SS, 90SS
		<b>1⅝</b>	BALL	3/8	1-1/8	180	W-65-XPD-M-PO-55	60, 90
	<b>1½</b>	<b>1⅝</b>	DELRIN	1/2	1-1/8	190	W-75-DPD-M-PO-55	70
			ROLLER	5/8	1-3/16	195	W-75-TPD-M-PO-55	
	<b>2</b>	<b>2⅙</b>	DELRIN	3/4	1-3/16	225	W-85-DPD-M-PO-55	20, 80
			ROLLER	3/4	1-3/16	225	W-105-TPD-M-PO-55	A100CS, A100SS
<b>2⅝</b>		DELRIN	3/4	1-3/16	225	W-85-TPD-M-PO-55	20, 80	
		DELRIN	3/4	1-3/16	225	W-105-DPD-M-PO-55	A100CS, A100SS	
<b>6</b>	<b>1⅜</b>	<b>1½</b>	DELRIN	1/2	1-1/8	190	W-66-DPD-M-PO-55	60, 60SS
		<b>1⅝</b>	BALL	3/8	1-1/8	190	W-66-XPD-M-PO-55	60
	<b>1½</b>	<b>1⅝</b>	DELRIN	1/2	1-1/8	225	W-76-DPD-M-PO-55	70
			ROLLER	5/8	1-3/16	230	W-76-TPD-M-PO-55	
	<b>2</b>	<b>2⅙</b>	DELRIN	3/4	1-3/16	250	W-86-DPD-M-PO-55	80
			ROLLER	3/4	1-3/16	250	W-86-TPD-M-PO-55	A100CS, A100SS
		<b>2⅝</b>	DELRIN	3/4	1-3/16	250	W-86-TPD-M-PO-55	80
			DELRIN	3/4	1-3/16	250	W-106-DPD-M-PO-55	A100CS, A100SS
<b>8</b>	<b>2</b>	<b>2⅙</b>	DELRIN	3/4	1-3/16	300	W-88-DPD-M-PO-55	80
		<b>2⅙</b>	ROLLER	3/4	1-3/16	300	W-108-TPD-M-PO-55	A100CS, A100SS
		<b>2⅝</b>	ROLLER	5/8	1-3/16	300	W-88-TPD-M-PO-55	80
		<b>2⅝</b>	DELRIN	3/4	1-3/16	300	W-108-DPD-M-PO-55	A100CS, A100SS

Members of:



**NSF**  
NATIONAL SANITATION  
FOUNDATION



**MATERIAL HANDLING  
INDUSTRY  
OF AMERICA®**



**Inflight**  
Food Service  
Association



**WORLDWIDE  
D-I-Y COUNCIL**



**icm**  
INSTITUTE OF CASTER  
MANUFACTURERS



**UL**  
UNDERWRITERS  
LABORATORY



**INDUSTRY MANUFACTURERS COUNCIL**



**nafem**





**MOLD-ON  
POLYURETHANE  
Polyolefin Core**

Load Capacity: 200 to 1,000 lbs.

Quality Features

- High load capacity.
- Good grease, oil, and chemical resistance.
- Floor protection.
- Will not chip, crack or become brittle.
- Non-marking.

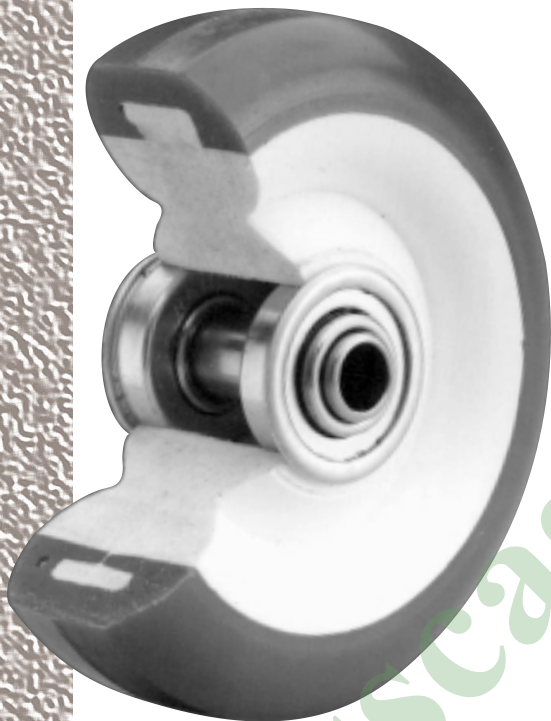

**Red Polyurethane tread is mechanically bonded to a high-strength polypropylene hub. Offers excellent wear resistance with minimum rolling effort. This sanitary wheel resists acids, oils, solvents, and most chemicals. Provides high load capacity, good floor protection at an economical price.**

TEMPERATURE RANGE:

-45° to +180°F

HARDNESS DUROMETER:

85-95 Shore A

COLOR:

Non-marking red on either white or black core.



**FLOOR MATERIALS & SURFACE CONDITIONS**

Linoleum, Vinyl, Composition	Concrete, Brick, Ceramic Tile	Hardwood, Wood Block, Planking	Asphalt, Rough Surfaces	Carpeted Surfaces	Metal Scraps on Floor	Excessive Heat	Excessive Cold	Harsh Chemicals or Moisture	Electrostatic Discharge
■	■	■	■					■	

*Bearing Selection*

DELIRIN



MACHINED BALL



ROLLER





# MOLD-ON POLYURETHANE

## Polypropylene Core

Diameter	Tread Width	Hub Length	Bearing	Bore, w/ Bearing	Bore, less bearing	Load Capacity	Part Number	Series Used In
<b>2½</b>	<b>1¾</b>	<b>1½</b>	DELIRIN	1/2	1-1/8	300	W-62 1/2-DADI-M-PO	60, 60SS
		<b>1⅝</b>	BALL	3/8	1-1/8	300	W-62 1/2-XADI-M-PO	60
<b>3</b>	<b>1</b>	<b>1⅙</b>	BALL	5/16	7/8	200	W-53-XADI-M-PO	50
			PLAIN	5/16	5/16	200	W-53-BADI-M-PO	50, 50SS
	<b>1¾</b>	<b>1½</b>	DELIRIN	1/2	1-1/8	300	W-63-DADI-M-PO	60, 60SS
		<b>1⅝</b>	BALL	3/8	1-1/8	300	W-63-XADI-M-PO	60
<b>3½</b>	<b>1¾</b>	<b>1½</b>	DELIRIN	1/2	1-1/8	360	W-63 1/2-DADI-M-PO	60, 90, 60SS, 90SS
		<b>1⅝</b>	BALL	3/8	1-1/8	360	W-63 1/2-XADI-M-PO	60, 90
<b>4</b>	<b>1</b>	<b>1⅙</b>	BALL	5/16	7/8	225	W-54-XADI-M-PO	50
			PLAIN	5/16	5/16	225	W-54-BADI-M-PO	50, 50SS
	<b>1¾</b>	<b>1½</b>	DELIRIN	1/2	1-1/8	400	W-64-DADI-M-PO	60, 90, 60SS, 90SS
			BALL	3/8	1-1/8	400	W-64-XADI-M-PO	60, 90
	<b>1½</b>	<b>1⅝</b>	DELIRIN	1/2	1-1/8	500	W-74-DADI-M-PO	70
			ROLLER	5/8	1-3/16	500	W-74-TADI-M-PO	
	<b>2</b>	<b>2⅙</b>	DELIRIN	3/4	1-3/16	600	W-84-DADI-M-PO	20, 80
				ROLLER	3/4	1-3/16	750	W-104-TADI-M-PO
			DELIRIN	5/8	1-3/16	750	W-84-TADI-M-PO	20, 80
				ROLLER	3/4	1-3/16	600	W-104-DADI-M-PO
<b>5</b>	<b>1</b>	<b>1⅙</b>	BALL	5/16	7/8	200	W-55-XADI-M-PO	50
			PLAIN	5/16	5/16	200	W-55-BADI-M-PO	50, 50SS
	<b>1¾</b>	<b>1½</b>	DELIRIN	1/2	1-1/8	400	W-65-DADI-M-PO	60, 90, 60SS, 90SS
			BALL	3/8	1-1/8	400	W-65-XADI-M-PO	60
	<b>1½</b>	<b>1⅝</b>	DELIRIN	1/2	1-1/8	600	W-75-DADI-M-PO	70
			ROLLER	5/8	1-3/16	600	W-75-TADI-M-PO	
	<b>2</b>	<b>2⅙</b>	DELIRIN	3/4	1-3/16	850	W-85-DADI-M-PO	20, 80
				ROLLER	3/4	1-3/16	1000	W-105-TADI-M-PO
DELIRIN			5/8	1-3/16	1000	W-85-TADI-M-PO	20, 80	
			ROLLER	3/4	1-3/16	850	W-105-DADI-M-PO	A100CS, A100SS
<b>6</b>	<b>1¾</b>	<b>1½</b>	DELIRIN	1/2	1-1/8	400	W-66-DADI-M-PO	60
			BALL	3/8	1-1/8	400	W-66-XADI-M-PO	
	<b>1½</b>	<b>1⅝</b>	DELIRIN	1/2	1-1/8	600	W-76-DADI-M-PO	70
			ROLLER	5/8	1-3/16	600	W-76-TADI-M-PO	
	<b>2</b>	<b>2⅙</b>	DELIRIN	3/4	1-3/16	900	W-86-DADI-M-PO	80
				ROLLER	3/4	1-3/16	1000	W-106-TADI-M-PO
			DELIRIN	5/8	1-3/16	1000	W-86-TADI-M-PO	80
				ROLLER	3/4	1-3/16	900	W-106-DADI-M-PO
<b>8</b>	<b>2</b>	<b>2⅙</b>	DELIRIN	3/4	1-3/16	1000	W-88-DADI-M-PO	80
			ROLLER	3/4	1-3/16	1000	W-108-TADI-M-PO	A100CS, A100SS
		DELIRIN	5/8	1-3/16	1000	W-88-TADI-M-PO	80	
			ROLLER	3/4	1-3/16	1000	W-108-DADI-M-PO	A100CS, A100SS

Members of:

NSF  
NATIONAL SANITATION  
FOUNDATION

MATERIAL HANDLING  
INDUSTRY  
OF AMERICA®

Inflight  
Food Service  
Association

WORLDWIDE  
D-I-Y COUNCIL

icm  
INSTITUTE OF CASTER  
MANUFACTURERS

UL  
UNDERWRITERS  
LABORATORY

INDUSTRY MANUFACTURERS COUNCIL

nafem





# WHEELS

Premium grade polyurethane tread is accurately cast and chemically bonded onto a high-grade cast iron core. All cores are machined and degreased then carefully prepped to assure a strong permanent bond.

Particularly recommended for heavy loads and tough floor conditions. Mold-on Polyurethane wheels are resistant to a wide range of chemicals, oils, and solvents making these the best wheels for extremely rugged applications. Many of these heavy-duty polyurethane wheels are expertly crafted at our plant in Detroit, Michigan.

## MOLD-ON POLYURETHANE

### Cast Iron Hub



Load Capacity: 200 to 10,000 lbs.

Load capabilities are based on intermittent use at speeds not in excess of 6 mph.

### Quality Features

- High load capacity.
- Excellent grease, oil, and chemical resistance.
- Good floor protection.
- High impact strength.
- Non-marking.

### SPECIFICATIONS

TEMPERATURE RANGE:  
-50° to +200°F

HARDNESS DUROMETER:  
90-92 Shore A

COLOR:  
Non-marking brown tread on either natural or blue painted core.

### FLOOR MATERIALS & SURFACE CONDITIONS

Linoleum, Vinyl, Composition	Concrete, Brick, Ceramic Tile	Hardwood, Wood Block, Planking	Asphalt, Rough Surfaces	Carpeted Surfaces	Metal Scraps on Floor	Excessive Heat	Excessive Cold	Harsh Chemicals or Moisture	Electrostatic Discharge
	■		■		■		■	■	

Diameter	Tread Width	Hub Length	Bearing	Bore, w/ Bearing	Bore, less bearing	Load Capacity	Part Number	Series Used In
2	1	1½	BALL	5/16	1-1/8	200	W-52-XADI-M-CI	50
2½	7/8	63/64	BALL	3/8	29/32	200	W-32 1/2-XADI-M-CI	30
	1¼	1½	BALL	3/8	1-3/16	400	W-62 1/2-XADI-M-CI	60
3	1¼	1½	BALL	3/8	1-3/16	400	W-63-XADI-M-CI	60
	1¾	1¾	PLAIN	1/2	-	400	W-63-BADI-M-CI	
			BALL	3/8	1-3/16	600	W-73-XADI-M-CI	70
3½	1¾	2¼	ROLLER	5/8	1-1/16	600	W-73-TADI-M-CI	20, 80
	1 7/8	2¼	ROLLER	5/8	1-3/16	800	W-103-TADI-M-CI	
4	1¼	1½	BALL	3/8	1-3/16	400	W-63 1/2-XADI-M-CI	60
4	1¾	1¾	ROLLER	5/8	1-1/16	600	W-74-TADI-M-CI	70
	1 7/8	2¼	ROLLER	5/8	1-3/16	800	W-104-TADI-M-CI	20, 80
	2	2¼	ROLLER	3/4	1-3/16	580	342-PS	A100, 400, R600

### Bearing Selection

MACHINED BALL



ROLLER



TAPERED ROLLER CUP AND CONE



# MOLD-ON POLYURETHANE Cast Iron Hub

Diameter	Tread Width	Hub Length	Bearing	Bore, w/ Bearing	Bore, less bearing	Load Capacity	Part Number	Series Used In	
<b>5</b>	<b>1<sup>3</sup>/<sub>8</sub></b>	<b>1<sup>1</sup>/<sub>4</sub></b>	ROLLER	5/8	1-1/16	600	W-75-TADI-M-CI	70	
	<b>1<sup>3</sup>/<sub>4</sub></b>	<b>2<sup>1</sup>/<sub>4</sub></b>	ROLLER	5/8	1-3/16	800	W-105-TADI-M-CI	20, 80, 4L	
			TAPERED ROLLER	9/16	1-3/8	800	W-105-YADI-M-CI		
<b>2</b>	<b>2<sup>1</sup>/<sub>4</sub></b>	ROLLER	3/4	1-3/16	700	352-PS	A100CS, 400, R600		
<b>6</b>	<b>1<sup>1</sup>/<sub>4</sub></b>	<b>1<sup>1</sup>/<sub>2</sub></b>	BALL	3/8	1-3/16	400	W-66-XADI-M-CI	60	
	<b>1<sup>1</sup>/<sub>2</sub></b>	<b>1<sup>3</sup>/<sub>4</sub></b>	ROLLER	5/8	1-1/16	560	W-76-TADI-M-CI	70	
	<b>1<sup>7</sup>/<sub>8</sub></b>	<b>2<sup>1</sup>/<sub>4</sub></b>	ROLLER	5/8	1-3/16	800	W-106-TADI-M-CI	80, 4L	
			ROLLER	<b>2<sup>1</sup>/<sub>4</sub></b>	3/4	1-3/16	1000	362-PS	A100CS, 400, R600
		<b>2<sup>5</sup>/<sub>8</sub></b>		1	1-3/4	1500	665-PS	R600	
	<b>2<sup>3</sup>/<sub>16</sub></b>	<b>2<sup>13</sup>/<sub>16</sub></b>	ROLLER	3/4	1-3/16	1100	W-606-TADI-M-CI	R600, 4L	
			TAPERED ROLLER	3/4	1-5/8	1100	W-606-YADI-M-CI		
	<b>2<sup>1</sup>/<sub>2</sub></b>	<b>2<sup>3</sup>/<sub>4</sub></b>	ROLLER	1	1-9/16	1650	669-PS	R600	
			TAPERED ROLLER	3/4	1-25/32	1650	100-6-PS	R100, 650	
	<b>2<sup>3</sup>/<sub>4</sub></b>	<b>3<sup>1</sup>/<sub>4</sub></b>	ROLLER	1-1/4	2-1/16	3500	W-4006-TADI-M-CI	4500, 5200	
TAPERED ROLLER			1-1/4	2-21/64	3500	W-4006-YADI-M-CI			
<b>3</b>	<b>3<sup>1</sup>/<sub>4</sub></b>	ROLLER	1	1-9/16	2000	551-6-PS	550		
		TAPERED ROLLER	3/4	1-25/32	2000	100-63-PS	R100, R110		
<b>8</b>	<b>2</b>	<b>2<sup>1</sup>/<sub>4</sub></b>	ROLLER	5/8	1-3/16	1000	W-88-TADI-M-CI	80, 4L	
				3/4	1-3/16	1350	382-PS	A100CS, 400	
			TAPERED ROLLER	19/32	1-3/8	1000	W-88-YADI-M-CI	80, 4L	
				3/4	1-25/32	1600	698-PS	-	
	<b>2<sup>1</sup>/<sub>2</sub></b>	<b>2<sup>3</sup>/<sub>4</sub></b>	ROLLER	1	1-9/16	2000	504-8-PS	500	
				TAPERED ROLLER	3/4	1-25/32	2000	655-8-PS	650
			ROLLER	<b>2<sup>13</sup>/<sub>16</sub></b>	3/4	1-3/16	1400	W-608-TADI-M-CI	D600, 4L
					TAPERED ROLLER	3/4	1-5/8	1400	
	<b>2<sup>3</sup>/<sub>4</sub></b>	<b>3<sup>1</sup>/<sub>4</sub></b>	ROLLER	1-1/4	2-1/16	2000	W-4008-TADI-M-CI	4500, 5200	
			TAPERED ROLLER	1-1/4	2-21/64	2000	W-4008-YADI-M-CI		
	<b>3</b>	<b>3<sup>1</sup>/<sub>4</sub></b>	ROLLER	3/4	1-13/16	2500	887-PS	800	
				1	1-13/16	2500	555-8-PS	550, 800	
TAPERED ROLLER				3/4	1-25/32	2500	100-7-PS	R100, R110	
	3/4	1-25/32	2500	100-8-PS					
<b>10</b>	<b>2</b>	<b>2<sup>1</sup>/<sub>4</sub></b>	ROLLER	3/4	1-3/16	1700	4102-PS	400, R600	
	<b>2<sup>1</sup>/<sub>2</sub></b>	<b>2<sup>3</sup>/<sub>4</sub></b>	ROLLER	1	1-9/16	2000	507-10-PS	500	
			TAPERED ROLLER	3/4	1-25/32	2000	656-10-PS	650	
	<b>2<sup>3</sup>/<sub>4</sub></b>	<b>3<sup>1</sup>/<sub>4</sub></b>	ROLLER	1-1/4	2-1/16	2000	W-4010-TADI-M-CI	4500, 5200	
			TAPERED ROLLER	1-1/4	2-21/64	2000	W-4010-YADI-M-CI	4500, 5200	
	<b>3</b>	<b>3<sup>1</sup>/<sub>4</sub></b>	ROLLER	1	1-13/16	2600	557-10-PS	550, 800	
				1	1-13/16	2600	8139-PS	800	
				1-1/4	2-7/16	3000	120-10-PS	R120	
				TAPERED ROLLER	3/4	1-25/32	2600	100-10-PS	R100, R110
					3/4	1-25/32	2600	100-9-PS	R100, R110
<b>4</b>	<b>4<sup>1</sup>/<sub>4</sub></b>	TAPERED ROLLER	1-1/4	2-7/16	4200	110-104-PS	R110, R120		
			1-1/4	2-21/64	4000	W-10X4-YADI-M-CI	-		
<b>5</b>	<b>5<sup>1</sup>/<sub>2</sub></b>	TAPERED ROLLER	1-1/4	2-21/64	10,000	10X5-YADI	5100		
<b>11</b>	<b>5</b>	<b>5<sup>1</sup>/<sub>4</sub></b>	TAPERED ROLLER	1-1/4	2-7/16	4500	127-110-PS	R120	
<b>12</b>	<b>2<sup>3</sup>/<sub>4</sub></b>	<b>3<sup>1</sup>/<sub>4</sub></b>	ROLLER	1-1/4	2-1/16	2000	W-4012-TADI-M-CI	4500, 5200	
			TAPERED ROLLER	1-1/4	2-21/64	2000	W-4012-YADI-M-CI	4500, 5200	
	<b>3</b>	<b>3<sup>1</sup>/<sub>4</sub></b>	TAPERED ROLLER	1-1/4	2-21/64	3500	100-12-PS	R100, R110	
	<b>4</b>	<b>4<sup>1</sup>/<sub>4</sub></b>	TAPERED ROLLER	1-1/4	2-7/16	4800	130-12-PS	R120	
1-1/4				2-21/64	4500	W-12X4-YADI-M-CI	-		
<b>16</b>	<b>4</b>	<b>4<sup>1</sup>/<sub>2</sub></b>	TAPERED ROLLER	1-1/4	2-21/64	6000	W-16X4-YADI-M-CI	-	
	<b>5</b>	<b>5<sup>1</sup>/<sub>4</sub></b>	TAPERED ROLLER	1-1/4	2-21/64	7500	4016-YADI-M-CI	4500 WORKSTAND, 5200	
				1-1/4	2-21/64	8500	4018-YADI-M-CI	4500 WORKSTAND, 5200	
			2	2-21/64	10,000	4018-YADI-M-CI-10K	8000		
<b>20</b>	<b>5</b>	<b>5<sup>1</sup>/<sub>4</sub></b>	TAPERED ROLLER	2	2-21/64	10,000	4020-YADI-M-CI-10K	8000	



# MOLD-ON SOFT POLYURETHANE

## Cast Iron Hub

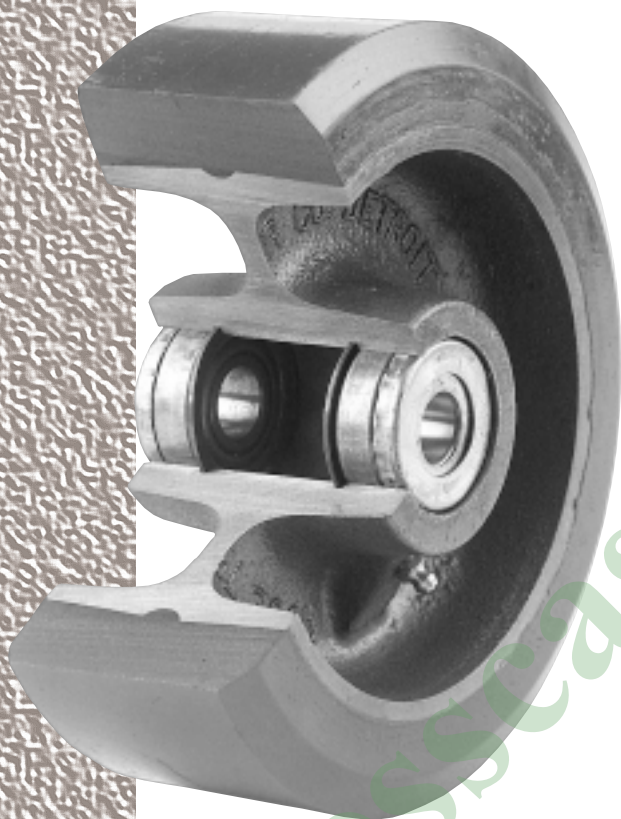

Load Capacity: 480 to 4,080 lbs.

Load capabilities are based on intermittent use at speeds not in excess of 3 mph.

### Quality Features

- Significant noise reduction.
- Excellent grease, oil, and chemical resistance.
- Faster flat spot recovery.
- Excellent floor protection.
- High impact strength.
- Non-marking.

**Wheel tread compounded from soft, premium grade polyurethane that is accurately cast then chemically bonded onto a cast iron core. All cores are machined and degreased then carefully prepped to assure a strong permanent bond. Particularly recommended for heavy loads and rough floor conditions. Soft polyurethane wheels resist a wide range of chemicals, oils, and solvents. All soft polyurethane wheels are expertly crafted at our plant in Detroit, Michigan.**

TEMPERATURE RANGE:  
-40°F to 200°F

HARDNESS DUROMETER:  
80 Shore A

COLOR:  
Red tread on either natural or blue painted core.

130



**BARNELL-ROSE**  
Division of Brevin Industries, Inc.

### FLOOR MATERIALS & SURFACE CONDITIONS

Linoleum, Vinyl, Composition	Concrete, Brick, Ceramic Tile	Hardwood, Wood Block, Planking	Asphalt, Rough Surfaces	Carpeted Surfaces	Metal Scraps on Floor	Excessive Heat	Excessive Cold	Harsh Chemicals or Moisture	Electrostatic Discharge
	■		■		■		■	■	

Bearing Selection

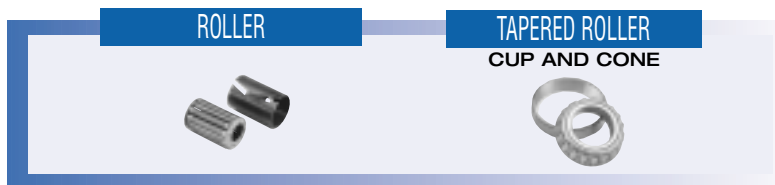



# MOLD-ON SOFT POLYURETHANE

## Cast Iron Hub

Diameter	Tread Width	Hub Length	Bearing	Bore, w/ Bearing	Bore, less bearing	Load Capacity LBS	Part Number	Series Used In
4	2	2¼	ROLLER	¾	1-3/16	480	342-PS8	A100CS, 400, R600
5	2	2¼	ROLLER	¾	1-3/16	550	352-PS8	A100CS, 400, R600
6	2	2¼	ROLLER	¾	1-3/16	600	362-PS8	A100CS, 400, R600
		2½		1	1-3/4	600	665-PS8	R600
	2½	2¾	ROLLER	1	1-9/16	960	669-PS8	
			TAPERED ROLLER	¾	1-25/32	960	100-6-PS8	R100, 650
			ROLLER	1	1-9/16	1080	551-6-PS8	550
8	2	2¼	ROLLER	¾	1-3/16	1560	382-PS8	A100CS, 400
			TAPERED ROLLER	¾	1-25/32	1560	698-PS8	—
	2½	2¾	ROLLER	1	1-9/16	1800	504-8-PS8	500
			TAPERED ROLLER	¾	1-25/32	1800	655-8-PS8	650
	3	3¾	ROLLER	1	1-13/16	2050	555-8-PS8	550, 800
			TAPERED ROLLER	¾	1-13/16	2050	887-PS8	800
				¾	1-25/32	2050	100-7-PS8	R100, R110
				¾	1-25/32	2050	100-8-PS8	
10	2	2¼	ROLLER	¾	1-3/16	1680	4102-PS8	400, R600
			ROLLER	1	1-9/16	2160	507-10-PS8	500
	2½	2¾	TAPERED ROLLER	¾	1-25/32	2160	656-10-PS8	650
			ROLLER	1	1-13/16	2400	557-10-PS8	550, 800
	3	3¾	ROLLER	1	1-13/16	2400	8139-PS8	800
				1-1/4	2-7/16	2400	120-10-PS8	R120
			TAPERED ROLLER	¾	1-25/32	2400	100-10-PS8	R100, R110
				¾	1-25/32	2400	100-9-PS8	
	4	4¾	TAPERED ROLLER	1-1/4	2-7/16	3120	110-104-PS8	R110, R120
	11	5	5¼	TAPERED ROLLER	1-1/4	2-7/16	4080	127-110-PS8
12	3	3¾	TAPERED ROLLER	1-1/4	2-21/64	2760	100-12-PS8	R100, R110
	4	4¾	TAPERED ROLLER	1-1/4	2-7/16	3600	130-12-PS8	R120

Members of:

NSF  
NATIONAL SANITATION  
FOUNDATION

MATERIAL HANDLING  
INDUSTRY  
OF AMERICA®

Inflight  
Food Service  
Association

WORLDWIDE  
D-I-Y COUNCIL

nafem

INDUSTRY MANUFACTURERS COUNCIL

icm  
INSTITUTE OF CASTER  
MANUFACTURERS





## STEEL DISC POLYURETHANE

Load Capacity: 350 to 800 lbs.

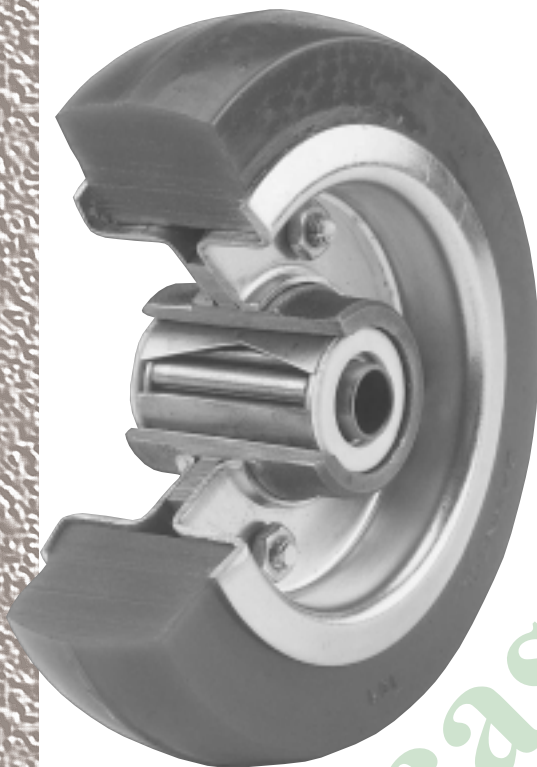

### Quality Features

- High load capacity.
- Low rolling resistance.
- Grease, oil, and chemical resistance.
- Worn tires can be replaced.
- Quiet operation.
- Good floor protection.

**Demountable Polyurethane tire is held firmly in place between two bright zinc plated steel discs which are securely bolted together. Bearings are mounted to provide quiet operation and smooth effortless ride. High-grade polyurethane tires provide excellent wear resistance on any surface while resisting oil, grease, and most chemicals. All steel disc Polyurethane wheels are expertly handcrafted at our factory in City of Industry, California.**



**ESD**

Available in Static Dissipative compound (between  $10^5$ - $10^{10}$  Ohms surface resistance) for good protection against electrostatic discharge (ESD).

**TEMPERATURE RANGE:**

-50° to +180°F

**HARDNESS DUROMETER:**

90-92 Shore A

**COLOR:**

Brown tread on bright zinc plated discs..



### FLOOR MATERIALS & SURFACE CONDITIONS

Linoleum, Vinyl, Composition	Concrete, Brick, Ceramic Tile	Hardwood, Wood Block, Planking	Asphalt, Rough Surfaces	Carpeted Surfaces	Metal Scraps on Floor	Excessive Heat	Excessive Cold	Harsh Chemicals or Moisture	Electrostatic Discharge
	■		■	■			■	■	

Bearing Selection

MACHINED BALL



ROLLER

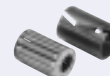



# STEEL DISC POLYURETHANE

Diameter	Tread Width	Hub Length	Bearing	Bore, w/ Bearing	Bore, less bearing	Load Capacity	Part Number	Series Used In
3½	1	1½	BALL	3/8	—	350	W-63 1/2-XADI-T-SD	60
4	1¼	1½	BALL	3/8	—	350	W-64-XADI-T-SD	60
		1¾		3/8	—	450	W-74-XADI-T-SD	70
5	1¾	1½	BALL	3/8	—	350	W-65-XADI-T-SD	60
		1¾		3/8	—	450	W-75-XADI-T-SD	70
	1⅞	2¼	ROLLER	5/8	1-3/16	550	W-105-TADI-T-SD	80, 4L0
	2⅜	2⅜		3/4	1-3/16	800	W-605-TADI-T-SD	D600, 4LA
6	1¼	1½	BALL	3/8	1-3/16	350	W-66-XADI-T-SD	60
	1⅞	2¼	ROLLER	5/8	1-3/16	550	W-106-TADI-T-SD	80, 4L0
	2⅜	2⅜		3/4	1-3/16	800	W-606-TADI-T-SD	D600, 4LA
8	1⅜	2¼	BALL	5/8	—	500	W-1008-XADI-T-SD	4L0
	1¾	2¼	ROLLER	1-1/4	2-1/16	700	W-1A08-TBADI-T-SD	4LA, D600
		2⅜		3/4	1-7/16	700	W-1A08-TADI-T-SD	
10	1¾	2½	BALL	5/8	—	550	W-1010-XADI-T-SD	—
	2	2¼	ROLLER	1-1/4	2-1/16	800	W-1A10-TBADI-T-SD	
12	2	2¼	ROLLER*	1-1/4	2-1/16	800	W-1A12-TBADI-T-SD	—

Members of:



UNDERWRITERS  
LABORATORY



INSTITUTE OF CASTER  
MANUFACTURERS



INDUSTRY MANUFACTURERS COUNCIL



NATIONAL SANITATION  
FOUNDATION



## PHENOLIC

Load Capacity: 400 to 8,000 lbs.

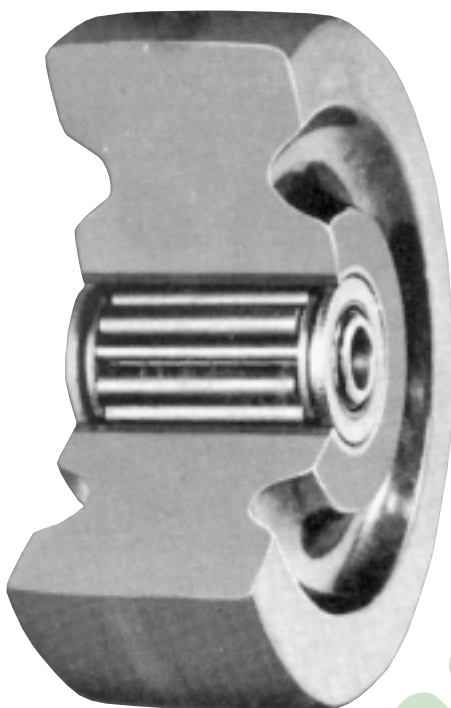

### Quality Features

- Economical.
- High load capacity.
- Low rolling resistance.
- Wide temperature range.
- Grease, oil, and chemical resistance.

**Phenolic wheels have high compressive strength and impact resistance. Not affected by most chemicals and will withstand temperatures up to 275°F. High temperature wheel is available up to 475°F.**

**Phenolic wheels offer a good value for many general and heavy-duty applications.**



**TEMPERATURE RANGE:**  
-65° to 275°F  
high temp to +475°F

**HARDNESS DUROMETER:**  
102 Rockwell E

**COLOR:**  
Non-marking black.

### FLOOR MATERIALS & SURFACE CONDITIONS

Linoleum, Vinyl, Composition	Concrete, Brick, Ceramic Tile	Hardwood, Wood Block, Planking	Asphalt, Rough Surfaces	Carpeted Surfaces	Metal Scraps on Floor	Excessive Heat	Excessive Cold	Harsh Chemicals or Moisture	Electrostatic Discharge
	■		■			■	■	■	

Bearing Selection

MACHINED BALL



ROLLER



**PHENOLIC**

Diameter	Tread Width	Hub Length	Bearing	Bore, w/ Bearing	Bore, less bearing	Load Capacity	Part Number	Series Used In	
<b>3</b>	1¼	1½	ROLLER	5/8	1-1/16	400	W-63-TPR	60, 60SS	
	1½	1¾		5/8	1-1/16	500	W-73-TPR	70	
	2	2¼		5/8	1-3/16	600	W-83-TPR	80	
<b>3¼</b>	2	2⅜	ROLLER	3/4	1-3/16	700	W-332-PR	400	
		2¼		5/8	1-3/16	600	W-103-TPR	20, 400	
<b>3½</b>	1¼	1½	ROLLER	5/8	1-1/16	400	W-63 1/2-TPR	60, 90, 60SS, 90SS	
<b>4</b>	1¼	1½	ROLLER	5/8	1-1/16	400	W-64-TPR	60, 90, 60SS, 90SS	
	1½	1¾	ROLLER	5/8	1-1/16	600	W-74-TPR	70	
	2	2⅜	ROLLER	3/4	1-3/16	1000	W-342-PR	400	
		2¼	ROLLER	3/4	1-3/16	800	W-342-PR		
			ROLLER	5/8	1-3/16	800	W-104-TPR	20, 80, A100, A100SS, 400	
<b>5</b>	1¼	1½	ROLLER	5/8	1-1/16	400	W-65-TPR	60, 90, 60SS, 90SS	
	1½	1¾	ROLLER	5/8	1-1/16	600	W-75-TPR	70	
	2	2⅜	ROLLER	3/4	1-3/16	1000	W-352-PR	400	
		2¼	ROLLER	3/4	1-3/16	1200	W-352-PR		
			ROLLER	5/8	1-3/16	1000	W-105-TPR	20, 80, 4L0, A100, A100SS, 400	
<b>6</b>	1½	1¾	ROLLER	5/8	1-1/16	800	W-76-TPR	70	
	1⅞	2¼	ROLLER	5/8	1-3/16	1200	W-106-TPR	80, 4L, A100, A100SS, 400	
	2	2⅜	ROLLER	3/4	1-3/16	1200	W-362-PR	400	
				3/4	1-3/16	1500	W-362-PR		
	2½	2⅜	ROLLER	3/4	1-3/16	1600	W-606-TPR	D600, 4L	
	2¾	¾	ROLLER	1-1/4	2-1/16	1600	W-4006-TPR	550, 4500, 5200	
				TAPERED ROLLER	1-1/4	2-21/64	1600	W-4006-YPR	R100, 650, 4500, 5200
	3	¾	ROLLER	1	1-15/16	2000	W-551-6-PR	550	
1-1/4				2-1/16	2000	W-4006-TPR-3	550, 4500, 5200		
TAPERED ROLLER				1-1/4	2-21/64	2000	W-4006-YPR-3	R100, R110, 4500, 5200	
			ROLLER	3/4	1-25/32	2000	W-100-63-PR	R100, R110	
<b>8</b>	2	2⅜	ROLLER	3/4	1-3/16	1400	W-382-PR	400	
		2¼	ROLLER	3/4	1-3/16	1500	W-382-PR	400	
				ROLLER	5/8	1-3/16	1400	W-88-TPR	80, 4L, 400
	2½	2⅜	ROLLER	3/4	1-3/16	2000	W-608-TPR	D600, 4L	
		¾	ROLLER	1	1-15/16	2000	W-504-8-PR	500	
	2¾	¾	TAPERED ROLLER	3/4	1-25/32	2000	W-655-8-PR	650	
			ROLLER	1-1/4	2-1/16	2000	W-4008-TPR	500, 4500, 5200	
				TAPERED ROLLER	1-1/4	2-21/64	2000	W-4008-YPR	650, 4500, 5200
	3	¾	ROLLER	1	1-15/16	2500	W-554-8-PR	550, 800	
				1-1/4	2-1/16	2500	W-4008-TPR-3	550, 4500, 5200	
TAPERED ROLLER				1-1/4	2-21/64	2500	W-4008-YPR-3	R100, R110, R120, 4500, 5200	
			ROLLER	1-1/4	2-7/16	2500	W-100-8-PR	R100, R110, R120	
<b>10</b>	2½	¾	ROLLER	1	1-15/16	2500	W-507-10-PR	500	
			TAPERED ROLLER	3/4	1-25/32	2000	W-655-8-PR	650	
	2¾	¾	ROLLER	1-1/4	2-1/16	2500	W-4010-TPR	500, 4500, 5200	
			TAPERED ROLLER	1-1/4	2-21/64	2500	W-4010-YPR	650, 4500, 5200	
	3	¾	ROLLER	1	1-15/16	2900	W-557-10-PR	550, 800	
				1-1/4	2-1/16	2900	W-4010-TPR-3	550, 4500, 5200	
			TAPERED ROLLER	1-1/4	2-21/64	2900	W-4010-YPR-3	R100, R110, R120, 4500, 5200	
			ROLLER	1-1/4	2-7/16	2900	W-100-10-PR	R100, R110, R120	
<b>12</b>	2½	¾	ROLLER	1-1/4	2-1/16	3000	W-4012-TPR	4500, 5200	
			TAPERED ROLLER	1-1/4	2-21/64	3000	W-4012-YPR		
	3	¾	ROLLER	1-1/4	2-1/16	3500	W-4012-TPR-3	R100, R110, 4500, 5200	
			TAPERED ROLLER	1-1/4	2-21/64	3500	W-4012-YPR-3	4500, 5200	
				ROLLER	1-1/4	2-7/16	3500	W-100-12-PR	R100, R110
	3½	4¼	TAPERED ROLLER	1-1/4	2-7/16	4000	W-130-12-PL	R120	
4	4¼	TAPERED ROLLER	1-1/4	2-7/16	8000	W-130-12-PR			



## POLYOLEFIN

Load Capacity: 150 to 900 lbs.

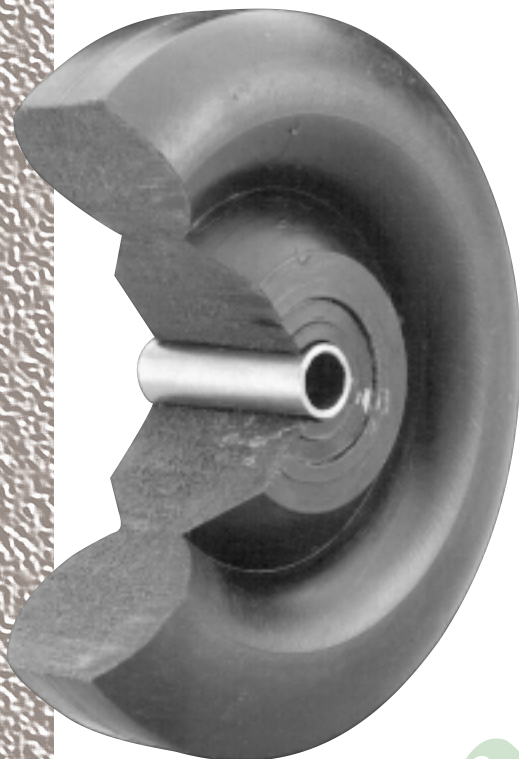

### Quality Features

- Economical.
- Impact resistant.
- Low rolling resistance.
- Grease, oil, and chemical resistance.

*These economical, impact resistant, hard plastic wheels offer low rolling resistance and good performance in wet conditions. Not affected by most oils, grease, or cleaning solvents, and will not mark floors. Solid high-grade material will not chip or crack under severe impact. Available in black (standard) or sanitary white colors.*



**TEMPERATURE RANGE:**

-45° to 200°F  
high temp to +550°F

**HARDNESS DUROMETER:**

85-95 Shore D

**COLOR:**

Non-marking black or sanitary white.



### FLOOR MATERIALS & SURFACE CONDITIONS

Linoleum, Vinyl, Composition	Concrete, Brick, Ceramic Tile	Hardwood, Wood Block, Planking	Asphalt, Rough Surfaces	Carpeted Surfaces	Metal Scraps on Floor	Excessive Heat	Excessive Cold	Harsh Chemicals or Moisture	Electrostatic Discharge
■	■			■				■	

Bearing Selection

MACHINED BALL



ROLLER





# POLYOLEFIN

Diameter	Tread Width	Hub Length	Bearing	Bore, w/ Bearing	Bore, less bearing	Load Capacity	Part Number	Series Used In	
									
<b>2</b>	<b>7/8</b>	<b>1 1/16</b>	PLAIN	5/16	5/16	150	W-52-BPO	50	
<b>2 1/2</b>	<b>1 3/8</b>	<b>1 1/2</b>	PLAIN	1/2	1/2	225	W-62 1/2-BPO	60, 60SS	
		<b>1 5/8</b>	BALL	3/8	1-1/8	300	W-62 1/2-XPO	60	
<b>3</b>	<b>1</b>	<b>1 3/16</b>	PLAIN	5/16	5/16	200	W-53-BPO	50, 50SS	
		<b>1 3/8</b>	<b>1 1/2</b>	PLAIN	1/2	1/2	240	W-63-BPO	60, 60SS
			<b>1 5/8</b>	BALL	3/8	1-1/8	300	W-63-XPO	60
	<b>1 13/16</b>	<b>1 7/8</b>	ROLLER	5/8	1-3/16	500	W-83-TPO	80	
<b>3 1/2</b>	<b>1 3/8</b>	<b>1 1/2</b>	PLAIN	1/2	1/2	265	W-63 1/2-BPO	60, 90, 60SS, 90SS	
		<b>1 5/8</b>	BALL	3/8	1-1/8	300	W-63 1/2-XPO	60, 90	
<b>4</b>	<b>1</b>	<b>1 3/16</b>	PLAIN	5/16	5/16	200	W-54-BPO	50, 50SS	
		<b>1 3/8</b>	<b>1 1/2</b>	PLAIN	1/2	1/2	265	W-64-BPO	60, 90, 60SS, 90SS
			<b>1 5/8</b>	BALL	3/8	1-1/8	400	W-64-XPO	60, 90
	<b>1 1/2</b>	<b>1 5/8</b>	PLAIN	1/2	1/2	375	W-74-BPO	70	
			ROLLER	5/8	1-3/16	450	W-74-TPO		
	<b>2</b>	<b>2 3/16</b>	PLAIN	3/4	3/4	550	W-104-BPO	A100, A100SS	
ROLLER			3/4	1-3/16	700	W-104-TPO			
			ROLLER	5/8	1-3/16	700	W-84-TPO	20, 80	
<b>5</b>	<b>1</b>	<b>1 3/16</b>	PLAIN	5/16	5/16	200	W-55-BPO	50, 50SS	
		<b>1 3/8</b>	<b>1 1/2</b>	PLAIN	1/2	1/2	265	W-65-BPO	60, 90, 60SS, 90SS
			<b>1 5/8</b>	BALL	3/8	1-1/8	400	W-65-XPO	60, 90
	<b>1 1/2</b>	<b>1 5/8</b>	PLAIN	1/2	1/2	540	W-75-BPO	70	
			ROLLER	5/8	1-3/16	600	W-75-TPO		
	<b>2</b>	<b>2 3/16</b>	PLAIN	3/4	3/4	650	W-105-BPO	A100, A100SS	
ROLLER			3/4	1-3/16	800	W-105-TPO			
			ROLLER	5/8	1-3/16	800	W-85-TPO	20, 80	
<b>6</b>	<b>1 3/8</b>	<b>1 1/2</b>	PLAIN	1/2	1/2	265	W-66-BPO	60, 60SS	
		<b>1 5/8</b>	BALL	3/8	1-1/8	400	W-66-XPO	60	
			PLAIN	1/2	1/2	600	W-76-BPO	70	
	<b>1 1/2</b>	<b>1 5/8</b>	ROLLER	5/8	1-3/16	600	W-76-TPO		
			PLAIN	3/4	3/4	700	W-106-BPO	A100, A100SS	
	<b>2</b>	<b>2 3/16</b>	ROLLER	5/8	1-3/16	800	W-86-TPO	80	
PLAIN			3/4	1-3/16	800	W-106-TPO	A100, A100SS		
<b>8</b>	<b>2</b>	<b>2 3/16</b>	PLAIN	3/4	3/4	900	W-108-BPO	A100CS, A100SS	
			ROLLER	5/8	1-3/16	900	W-88-TPO	80	
			ROLLER	3/4	1-3/16	900	W-108-TPO	A100, A100SS	

Members of:



**NSF**  
NATIONAL SANITATION  
FOUNDATION



**MATERIAL HANDLING  
INDUSTRY  
OF AMERICA**



**Inflight**  
Food Service  
Association



**WORLDWIDE  
D-I-Y COUNCIL**



**icm**  
INSTITUTE OF CASTER  
MANUFACTURERS



**UL**  
UNDERWRITERS  
LABORATORY



**INDUSTRY MANUFACTURERS COUNCIL**



**nafem**



Load Capacity: 125 to 5,000 lbs.

# WHEELS

Made from high-grade iron castings, these wheels provide the highest load capacity per wheel diameter, are easy to roll, and perform extremely well on rough and chip-littered floors that could damage other types of wheels. Tread face is machined concentric to bearing bore for smooth, jolt-free operation. Wheels are designed with heavy rims and extra thick cross sections for maximum strength, high capacity, and long service life.

## CAST IRON (Semi-Steel)

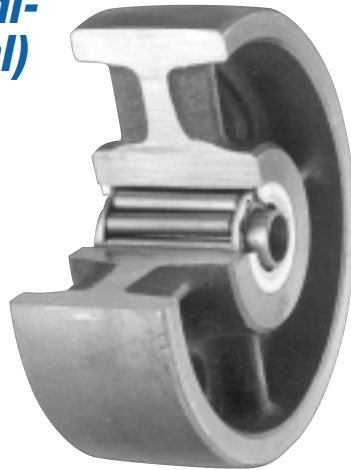

### Quality Features

- High load capacity.
- Low rolling resistance.
- High impact.
- Long service life.
- Withstands high temperatures.

### SPECIFICATIONS

TEMPERATURE RANGE:  
-40 to +800°F

HARDNESS DUROMETER:  
100-300 Brinell

COLOR:  
Natural or blue painted finish.

Diameter	Tread Width	Hub Length	Bearing	Bore, w/ Bearing	Bore, less bearing	Load Capacity	Part Number	Series Used In
<b>2</b>	3/4	7/8	PLAIN	5/16	—	125	W-9-BCI	9
	<b>1</b>	<b>1</b> 1/2	PLAIN	7/16	—	200	W-52-BCI	50
<b>2 1/2</b>	<b>1</b>	<b>1</b> 1/2	PLAIN	7/16	—	200	W-52 1/2-BCI	50
	<b>1 1/4</b>	<b>1</b> 1/2	PLAIN	1/2	—	400	W-62 1/2-BCI	60
<b>3</b>	7/8	<b>1</b> 1/2	PLAIN	7/16	—	200	W-53-BCI	50
	<b>1 1/4</b>	<b>1</b> 1/2	PLAIN	1/2	—	400	W-63-BCI	60
	<b>1 3/8</b>	<b>1</b> 3/4	BALL	3/8	1-1/8	600	W-73-XCI	70
			PLAIN	5/8	—	600	W-73-BCI	70
ROLLER	5/8	1-1/16	600	W-73-TCI	70			
<b>1 7/8</b>	<b>2</b> 1/4	ROLLER	5/8	1-3/16	1000	W-103-TCI	20, 80	
<b>3 1/2</b>	<b>1 1/4</b>	<b>1</b> 1/2	PLAIN	1/2	—	400	W-63 1/2-BCI	60
<b>4</b>	7/8	<b>1</b> 1/2	PLAIN	7/16	—	200	W-54-BCI	50
	<b>1 1/4</b>	<b>1</b> 1/2	PLAIN	1/2	—	400	W-64-BCI	60
	<b>1 3/8</b>	<b>1</b> 3/4	ROLLER	5/8	1-1/16	600	W-74-TCI	70
	<b>1 3/4</b>	<b>2</b> 1/4	ROLLER	5/8	1-3/16	1000	W-104-TCI	80, 20
	<b>2</b>	<b>2</b> 1/4	ROLLER	3/4	1-3/16	1000	342-CI	A100CS, 400, R600

138

### Bearing Selection

PLAIN STEEL BUSHING



ROLLER



TAPERED ROLLER  
CUP AND CONE





## FLOOR MATERIALS & SURFACE CONDITIONS

Linoleum, Vinyl, Composition	Concrete, Brick, Ceramic Tile	Hardwood, Wood Block, Planking	Asphalt, Rough Surfaces	Carpeted Surfaces	Metal Scraps on Floor	Excessive Heat	Excessive Cold	Harsh Chemicals or Moisture	Electrostatic Discharge
	■		■		■	■		■	■

Diameter	Tread Width	Hub Length	Bearing	Bore, w/ Bearing	Bore, less bearing	Load Capacity	Part Number	Series Used In
<b>5</b>	7/8	1 1/8	PLAIN	7/16	—	200	W-55-BCI	50
	1 1/4	1 1/2	BALL	3/8	1-1/8	400	W-65-XCI	60
			PLAIN	5/8	—	400	W-65-BCI	
	1 1/2	1 3/4	ROLLER	5/8	1-1/16	600	W-75-TCI	70
	1 7/8	2 1/4	ROLLER	5/8	1-3/16	1000	W-105-TCI	80, 4L, 20
			TAPERED ROLLER	9/16	1-3/8	1000	W-105-YCI	
	2	2 1/4	ROLLER	3/4	1-3/16	1300	352-CI	A100CS, 400, R600
2 3/16	2 13/16	ROLLER	3/4	1-3/16	1400	W-605-TCI	D600, 4L	
		TAPERED ROLLER	3/4	1-5/8	1400	W-605-YCI		
<b>5 3/4</b>	2 1/2	2 3/4	ROLLER	1	1-9/16	1800	500-5-CI	500, R600
			TAPERED ROLLER	3/4	1-9/16	1800	100-5-CI	R100
			ROLLER	1	1-9/16	3000	662-CI	R600
			TAPERED ROLLER	3/4	1-9/16	3000	100-57-CI	R100
<b>6</b>	1 1/4	1 1/2	BALL	3/8	1-1/8	400	W-66-XCI	60
			PLAIN	1/2	—	400	W-66-BCI	
	1 1/2	1 3/4	PLAIN	9/16	—	600	W-76-BCI	70
			ROLLER	5/8	1-1/16	600	W-76-TCI	
	1 7/8	2 1/4	ROLLER	5/8	1-3/16	1000	W-106-TCI	80, 4L
	2	2 1/4	ROLLER	3/4	1-3/16	1600	362-CI	A100CS, 400, R600
			TAPERED ROLLER	3/4	1-3/16	1600	696-CI	
	2 3/16	2 13/16	ROLLER	3/4	1-3/16	1400	W-606-TCI	D600, 4L
			TAPERED ROLLER	3/4	1-5/8	1400	W-606-YCI	
	2 1/2	2 3/4	ROLLER	1	1-9/16	3000	501-6-CI	500, R600
TAPERED ROLLER			3/4	1-9/16	3000	100-6-CI	R100, 650	
ROLLER			1-1/4	2-1/16	5000	W-4006-TCI	4500, 5200	
TAPERED ROLLER			1-1/4	2-21-64	5000	W-4006-YCI		
3	3 3/4	ROLLER	1	1-13/16	3100	551-6-CI	550	
		TAPERED ROLLER	3/4	1-13/16	3100	100-63-CI	R100	
<b>8</b>	2	2 1/4	ROLLER	3/4	1-3/16	1800	382-CI	A100CS, 400, R600
			ROLLER	5/8	1-1/16	1500	W-88-TCI	
	2 1/4	2 13/16	ROLLER*	1-1/4	2-1/16	2700	W-608-TBCI	D600, 4L
			ROLLER	3/4	1-3/16	2700	W-608-TCI	
			TAPERED ROLLER	3/4	1-5/8	2700	W-608-YCI	
	2 1/2	2 3/4	ROLLER	1	1-9/16	3100	504-8-CI	500
			TAPERED ROLLER	3/4	1-9/16	3100	655-8-CI	650
			ROLLER	1-1/4	2-1/16	5000	W-4008-TCI	4500, 5200
			TAPERED ROLLER	1-1/4	2-21-64	5000	W-4008-YCI	
	3	3 3/4	TAPERED ROLLER	1-1/4	2-1/16	6000	120-8-CI	R120, 800
TAPERED ROLLER			3/4	2-1/16	4000	100-8-CI	R100, R110	
4	4 1/4	TAPERED ROLLER	1-1/4	2-1/16	4000	126-8-CI	R110, R120	
<b>10</b>	2 1/2	2 3/4	ROLLER	1	1-15/16	3300	507-10-CI	500
			TAPERED ROLLER	3/4	1-15/16	3300	656-10-CI	650
	2 3/4	3 3/4	ROLLER	1-1/4	2-1/16	5000	W-4010-TCI	4500, 5200
			TAPERED ROLLER	1-1/4	2-21-64	5000	W-4010-YCI	
	3	3 3/4	ROLLER	1	1-13/16	4000	557-10-CI	800
			TAPERED ROLLER	1-1/4	1-13/16	6000	120-10-CI	R120, 800
4	4 1/4	TAPERED ROLLER	3/4	1-13/16	4000	100-10-CI	R100, R110	
<b>12</b>	2 3/4	3 3/4	ROLLER	1-1/4	2-1/16	5000	W-4012-TCI	4500, 5200
			TAPERED ROLLER	1-1/4	2-21-64	5000	W-4012-YCI	



WHEELS

Load Capacity: 2,000 to 10,000 lbs.

**HIGH STRENGTH METAL WHEELS**

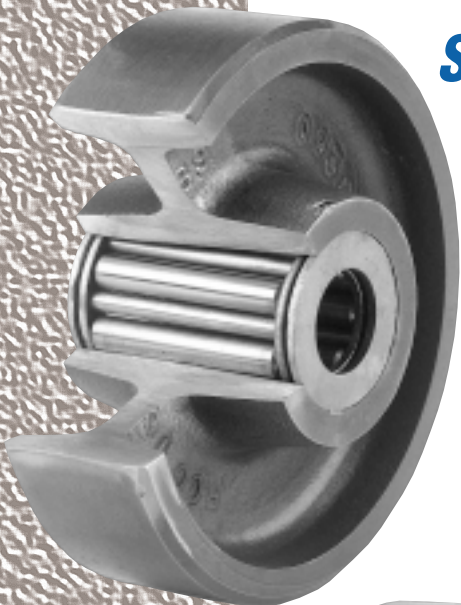

DROP FORGED STEEL WHEEL

DUCTILE IRON WHEEL

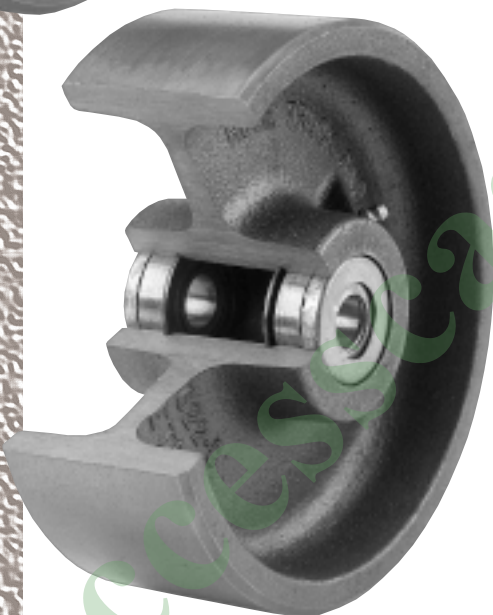

**Quality Features**

- High load capacity.
- Low rolling resistance.
- Resists severe impact.
- Long service life.
- Withstands high temperatures.

**Virtually indestructible, these wheels are made from the highest-grade drop forged steel for ultimate strength and load carrying capacity. Wheel faces are machined concentric with bearing bore for smooth, even rotation at all times. Heavily sectioned rims and solid web design assure years of trouble free service.**

**TEMPERATURE RANGE:**

Drop Forged: -60 to 800°F  
Ductile Iron: -60 to 800°F

**HARDNESS DUROMETER:**

Drop Forged: 195-200 Brinell  
Ductile Iron: 225-265 Brinell

**COLOR:**

Natural metal finish.



**FLOOR MATERIALS & SURFACE CONDITIONS**





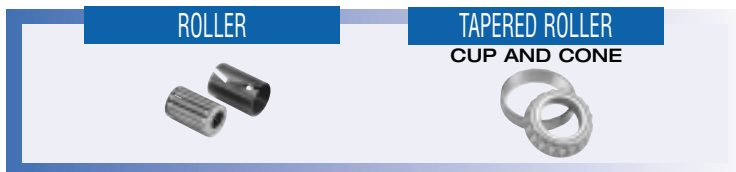

Linoleum, Vinyl, Composition	Concrete, Brick, Ceramic Tile	Hardwood, Wood Block, Planking	Asphalt, Rough Surfaces	Carpeted Surfaces	Metal Scraps on Floor	Excessive Heat	Excessive Cold	Harsh Chemicals or Moisture	Electrostatic Discharge
	■		■		■	■	■	■	■

*Bearing Selection*

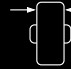
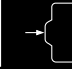



## DROP FORGED STEEL

Diameter	Tread Width	Hub Length	Bearing	Bore, w/ Bearing	Bore, less bearing	Load Capacity	Part Number	Series Used In
								
<b>5<sup>3</sup>/<sub>4</sub></b>	<b>1<sup>3</sup>/<sub>4</sub></b>	<b>2<sup>3</sup>/<sub>4</sub></b>	ROLLER	1	1-3/4	3000	663-FS	R600, 800
			TAPERED ROLLER	3/4	1-25/32	3000	695-FS	695
<b>6</b>	<b>2</b>	<b>2<sup>3</sup>/<sub>4</sub></b>	TAPERED ROLLER	3/4	1-25/32	2000	651-6-FS	650
<b>7</b>	<b>3</b>	<b>3<sup>3</sup>/<sub>4</sub></b>	TAPERED ROLLER	1-1/4	2-21/64 to 2-7/8	2500	120-7-FS	R120
<b>8</b>	<b>2</b>	<b>3<sup>3</sup>/<sub>4</sub></b>	TAPERED ROLLER	3/4	1-25/32	3500	110-82-FS	SPECIAL
	<b>3</b>	<b>3<sup>3</sup>/<sub>4</sub></b>		1-1/4	2-21/64 to 2-7/8		120-8-FS	R120
				3/4	1-25/32	5500	110-8-FS	R110

### Members of:



UNDERWRITERS  
LABORATORY

INSTITUTE OF CASTER  
MANUFACTURERS



INDUSTRY MANUFACTURERS COUNCIL



NATIONAL SANITATION  
FOUNDATION

# WHEELS

Made from 100% type 303 stainless steel bar, these wheels offer the highest degree of sanitation and corrosion protection. Wheels are machined with a hub projection on each side and with a slightly crowned tread face for easy mobility and floor protection.

## STAINLESS STEEL

Load Capacity: 200 to 1,000 lbs.



### Quality Features

- High corrosion protection.
- Low rolling resistance.
- High impact.
- Long service life.
- Withstands high temperatures.

### SPECIFICATIONS

TEMPERATURE RANGE:  
-80°F to 800°F

HARDNESS DUROMETER:  
145-160 Brinell

COLOR:  
Natural stainless steel.

### FLOOR MATERIALS & SURFACE CONDITIONS

Linoleum, Vinyl, Composition	Concrete, Brick, Ceramic Tile	Hardwood, Wood Block, Planking	Asphalt, Rough Surfaces	Carpeted Surfaces	Metal Scraps on Floor	Excessive Heat	Excessive Cold	Harsh Chemicals or Moisture	Electrostatic Discharge
	■		■		■	■	■	■	■

### STAINLESS STEEL BUSHING



142

Diameter	Tread Width	Hub Length	Bearing	Bore, w/ Bearing	Bore, less bearing	Load Capacity	Part Number	Series Used In
<b>2</b>	<b>1</b>	<b>1</b>	PLAIN	5/16	7/16	200	W-51-BSS	50
<b>2½</b>	<b>1</b>	<b>1</b>	PLAIN	5/16	7/16	200	W-52 1/2-BSS	50
	<b>1¼</b>	<b>1⅙</b>		3/8	1/2	400	W-62 1/2-BSS	60
<b>3</b>	<b>¾</b>	<b>1</b>	PLAIN	5/16	7/16	200	W-53-BSS	50
	<b>1¼</b>	<b>1⅙</b>		3/8	1/2	400	W-63-BSS	60
<b>3½</b>	<b>7/8</b>	<b>1⅙</b>	PLAIN	3/8	1/2	400	W-63 1/2-BSS	60
<b>4</b>	<b>7/8</b>	<b>1</b>	PLAIN	5/16	7/16	200	W-54-BSS	50
	<b>1¼</b>	<b>1⅙</b>		3/8	1/2	400	W-64-BSS	60
	<b>1½</b>	<b>1⅝</b>		1/2	3/4	600	W-74-BSS	70
	<b>2</b>	<b>2¾</b>		1/2	3/4	1000	W-104-BSS	A100SS
<b>5</b>	<b>7/8</b>	<b>1</b>	PLAIN	5/16	7/16	200	W-55-BSS	50
	<b>1¼</b>	<b>1⅙</b>		3/8	1/2	400	W-65-BSS	60
	<b>1½</b>	<b>1⅝</b>		1/2	3/4	600	W-75-BSS	70
	<b>2</b>	<b>2¾</b>		1/2	3/4	1000	W-105-BSS	A100SS
<b>6</b>	<b>1½</b>	<b>1⅝</b>	PLAIN	1/2	3/4	600	W-76-BSS	70
	<b>2</b>	<b>2¾</b>		1/2	3/4	1000	W-106-BSS	A100SS
<b>8</b>	<b>1½</b>	<b>1⅝</b>	PLAIN	1/2	3/4	600	W-78-BSS	70
	<b>2</b>	<b>2¾</b>		1/2	3/4	1000	W-108-BSS	A100SS



Load Capacity: 825 to 2,200 lbs.



## V-GROOVE

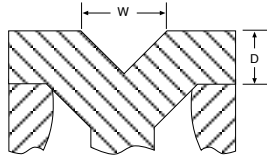

### Bearing Selection

**ROLLER**

**TAPERED ROLLER  
CUP AND CONE**

Wheels are cast from high-grade, close-grained gray iron metal. Wheel face and 90° V-groove are precision machined concentric with bearing bore for smooth even operation on inverted angle track. Groove is machined for equal load distribution when on track. Generous tread widths provide ample load bearing surface on either side of the "V" so wheels can also be used on flat surfaces.

Diameter	Tread Width	Hub Length	Bearing	Bore, w/ Bearing	Bore, less bearing	Load Capacity	Part Number	Series Used In
<b>4</b>	<b>1½</b>	<b>1¾</b>	ROLLER	3/4	1-3/16	825	341-VS	70
				3/4	1-3/16	900	342-VS	80, A100, R400
	<b>2</b>	<b>2¼</b>		<b>2¾</b>	1	1-3/4	1200	642-VS
<b>5¾</b>	<b>2½</b>	<b>2¾</b>	ROLLER	1	1-9/16	2500	662-VS	R600
<b>6</b>	<b>2½</b>	<b>2¾</b>	ROLLER	1	1-9/16	3000	669-VS	R600, D600, 4L
<b>8</b>	<b>3</b>	<b>3¾</b>	TAPERED ROLLER	1-1/4	2-7/16	4000	883-VS	R800
<b>10</b>	<b>3</b>	<b>3¾</b>	TAPERED ROLLER	1-1/4	2-7/16	5000	8132-VS	R800

Load Capacity: 825 to 2,200 lbs.

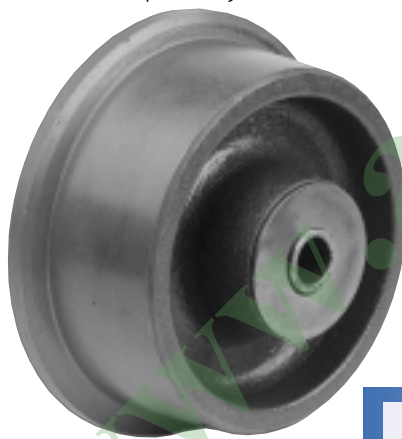

## FLANGED

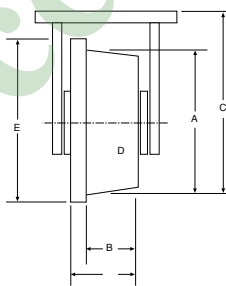

**ROLLER**

**TAPERED ROLLER  
CUP AND CONE**

Track wheels utilize a sturdy solid web cross sectional design with no holes or spikes to weaken the hub. Cast from close-grained gray iron metal and perfectly machined concentric with bearing bore for smooth, "thump-free" operation. Ideal for transfer carts, kiln carts, or any equipment that must be accurately guided between work and processing stations.

Diameter "A"	Flange Width "B"	Type	Part Number	Load Cap. (lbs.)	Height to Flange "C"	Width "D" (Inclg. Flange)	Flange Dia. "E"	Height (Inclg. Flange)	Approx. Weight
<b>5¾</b>	<b>2½</b>	Flat Tread	RC-752-FT	2200	8 5/8	2 5/8	7	9 1/4	23
<b>6</b>	<b>2½</b>	Tapered Tread	RC-762-FT	2200	8 3/4	2 5/8	7	9 1/4	23