

Load Capacity: 300 to 600 lbs.

70 SERIES

Medium Duty Industrial

Quality Features

- **FOUR-SIDED, DOUBLE BALL RACEWAY.**
Hardened steel ball bearings and secondary thrust bearings touch the swivel raceway "on all four sides." This protects the central king pin from shock loading for free swiveling under heavy loads.
- **HEAT-TREATED MOVING PARTS.**
All moving parts are heat treated to a precise molecular depth and Rockwell hardness. This extends caster life under rugged conditions and shock loads.
- **RACEWAY DUST CAP.**
Dust cap protects the raceway from contamination by dust, dirt, moisture, and other debris.
- **TWO-PIECE RIGID CASTER.**
Rigid caster utilizes a welded top plate and yoke design instead of a one-piece stamped yoke as used on competitive brands.
- **THREAD GUARD.**
Keep unwanted materials out of the wheel bearings thus increasing the life of the caster. Standard on most wheels.

SWIVEL

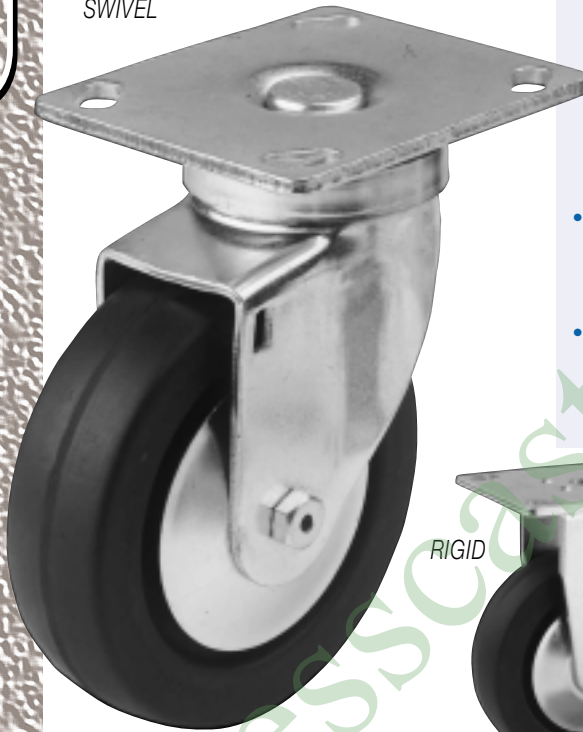

RIGID

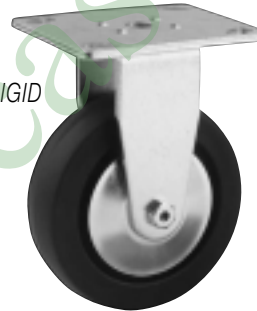

Strong, rugged and easy rolling, these casters provide high load capacity within a narrow profile. Offered with a wide selection of wheels, stems, and mounting plates. Formed steel yoke and double ball bearing raceways make these 70 Series casters as strong as they are durable.

Typical uses include:

- Warehouse Trucks
- Baking Ovens
- Commercial Ovens
- Platform Lifts
- Waste Receptacles
- Kitchen Fryers, and Equipment

Available with combination wheel brake and swivel lock. Standard finish is Zinc Plated Steel. Custom finishes are available.

Options

- Maintenance Free Swivel Bearings
- High-Temperature Wheels
- Conductive or Static-Dissipative Wheels
- Gray, Non-Marking Wheels
- Powder Coated Finishes

FOUR SIDED DOUBLE BALL BEARING RACEWAY 70 SERIES

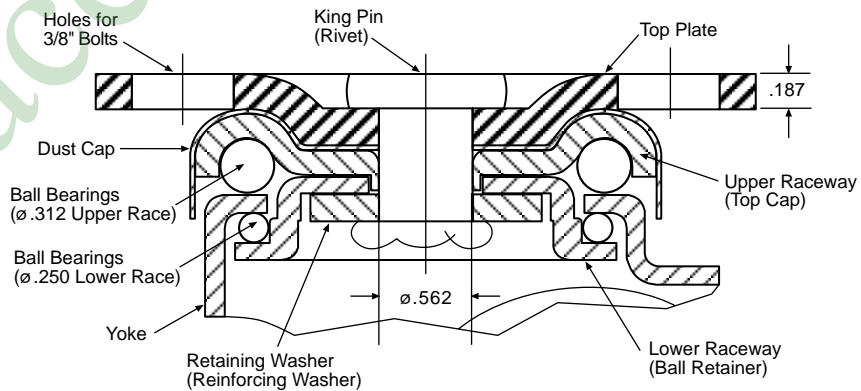

Wheel Selection

ADVANCED ELASTOMER	NEOPRENE RUBBER	HI-CAP NEOPRENE	HARD RUBBER	NEOPRENE OR POLYURETHANE STEEL DISC	CAST IRON HUB MOLD-ON POLYURETHANE
PAGE 106	PAGE 108	PAGE 110	PAGE 112	PAGE 118	PAGE 128

TOP PLATE

STANDARD

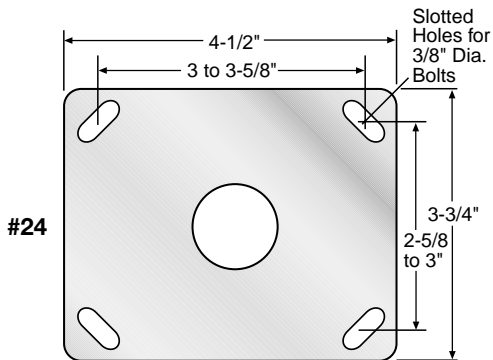

ALTERNATES

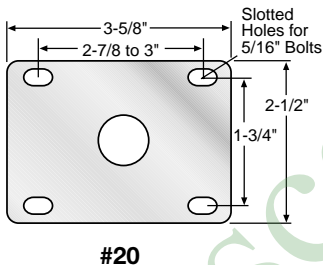
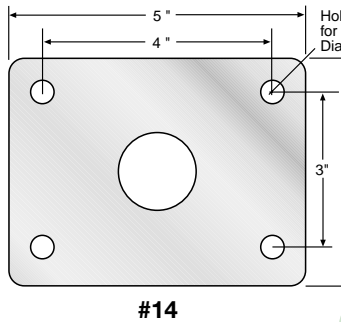
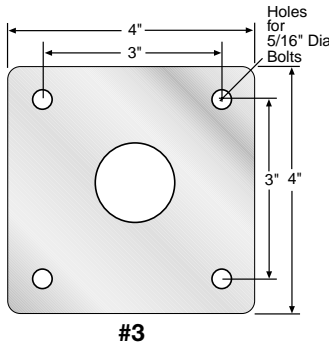

Medium-Duty
Industrial

STEMS

"O" STEM TABLE

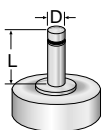

Dimension D	Dimension L	Stem Number
*1/2"	1-1/2"	O70-12-112
*5/8"	2"	O70-58-2
*3/4"	2"	O70-34-2
*7/8"	2"	O70-78-2
*1"	2-1/2"	O70-1-212

Other stem sizes and dimensions available.
*Special Order/Minimum Quantity

"L" STEM TABLE

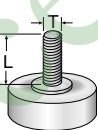

Dimension T	Dimension L	Stem Number
1/2"-13	1-1/2"	L70-1213-112
*1/2"-13	2"	L70-1213-2
5/8"-11	2"	L70-5811-2
*5/8"-11	2-1/2"	L70-5811-212
*3/4"-10	1-1/2"	L70-3410-112
3/4"-10	2"	L70-3410-2
*3/4"-10	2-1/2"	L70-3410-212

Other stem sizes and dimensions available.
*Special Order/Minimum Quantity

"E" STEM TABLE

Dimension D	
ROUND	SQUARE
3/4"	3/4"
7/8"	7/8"
1"	1"
1-1/16"	1-1/8"
1-1/8"	1-1/4"
1-1/4"	1-3/8"
1-3/8"	1-1/2"
1-7/16"	1-5/8"
1-1/2"	1-3/4"
1-9/16"	2"
1-5/8"	
1-3/4"	
1-7/8"	
1.9"	

"7/8" round" stem

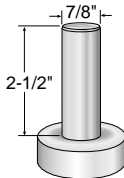

"7/8" square" stem

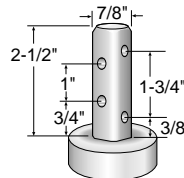

Subtract .187" from overall height for stem casters.

POLYOLEFIN HUB

POLYURETHANE

PAGE 126



THERMO PLASTIC RUBBER

PAGE 124



PHENOLIC

PAGE 134

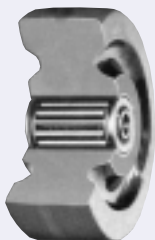

POLYOLEFIN

PAGE 136



CAST IRON

PAGE 138

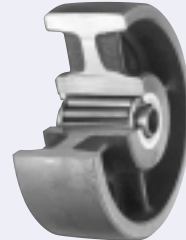

Access Casters (877) 881-6814

Series continued

BRAKES

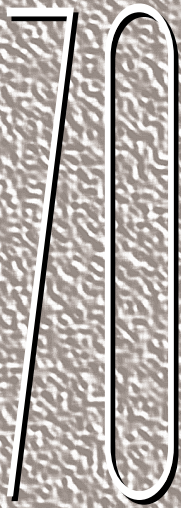

The National Sanitation Foundation specifications require smoothness of caster design and a freedom from debris collecting areas to insure easy cleaning of the caster. Designs which insure maximal grease retention in the swivel portion of the caster are also specifically required by the NSF. Our casters in the 50, 60 & 70 Series are listed by the National Sanitation Foundation.



BARNELL-ROSE
Division of Bostwick Industries, Inc.

Wheel Brake (WB)

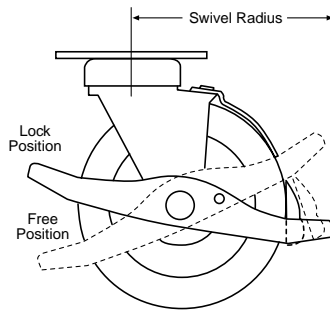

Wheel Brake

Operates by a foot pedal lever that has a rubber brake pad to form a positive brake action when the brake lever is pressed down to engage. To restore back to the normal position, simply reverse the action to disengage the brake. Easy to operate and trouble free.

Radial Brake (RB)

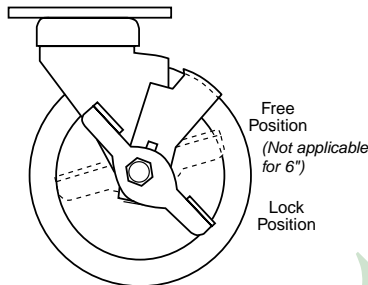

Radial Brake

Exceptional brake for light and medium duty applications, either industrial or institutional. Side pedal engages tread lock to restrain wheel movement. Brake kit available for field installation.

Available in 73, 74 & 75 Series only.

Four Position Swivel Lock (SL)

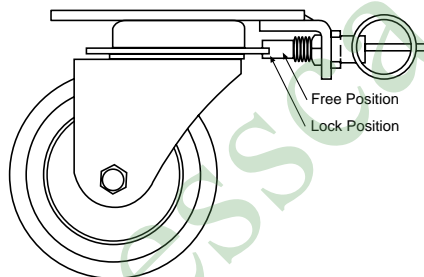

Four Position Swivel Lock

A horizontal four position swivel lock with a spring loaded plunger to securely hold the swivel in the slotted position desired. Plunger can be put into a neutral position for free swiveling action.

Combination Swivel & Wheel Brake (CB)

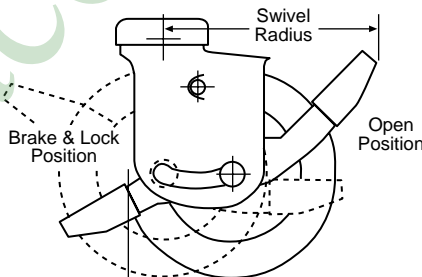

For 4" and 5" only.

Combination Swivel & Wheel Brake

For medium heavy loads, this foot lever operated combination swivel lock and wheel brake maintains the same height when the brake is engaged or in the released position. Also, the same height is maintained when used with its companion casters as swivel or rigid. For easy operation by simply stepping on the foot lever in the high position and reversing the action to release the brake to a free rolling position. Available in 4" and 5" only.

Diameter	Tread Width	Load Capacity	Wheel Material	Bearing	Swivel Part Number	Rigid Part Number	Approx. Weight	Overall Height	Swivel Radius
3	1 3/8	300	NEOPRENE RUBBER	ACETAL	73-24-PDN	73-24-PRDN	3	4-7/16	3
				ROLLER	73-24-TDN	73-24-TRDN			
		375	HI-CAP NEOPRENE	ACETAL	73-24-PKN	73-24-PRKN			
				ROLLER	73-24-TKN	73-24-TRKN			
		550	HARD RUBBER	ACETAL	73-24-PH	73-24-PRH			
				ROLLER	73-24-TH	73-24-TRH			
	1 1/2	600	600	CAST IRON	ROLLER	73-24-TCI	73-24-TRCI	3-3/4	
					ROLLER	73-24-TPR	73-24-TRPR	3	
			600	PHENOLIC	ROLLER	73-24-TPR	73-24-TRPR	3	
					ROLLER	73-24-TADI-M-CI	73-24-TRADI-M-CI	3-3/4	

Access Casters (877) 881-6814

Diameter	Tread Width	Load Capacity	Wheel Material	Bearing	Swivel Part Number	Rigid Part Number	Approx. Weight	Overall Height	Swivel Radius	
4	1 1/4	300	STEEL DISC NEOPRENE	BALL	74-24-XDN-T-SD	74-24-XRDN-T-SD	5-1/4	5-7/16	3-3/8	
			NEOPRENE RUBBER	ACETAL	74-24-PDN	74-24-PRDN				
	1 3/8	300	HI-CAP NEOPRENE	ROLLER	74-24-TDN	74-24-TRDN	3-1/2			
			HI-CAP NEOPRENE	ACETAL	74-24-PKN	74-24-PRKN				
			HI-CAP NEOPRENE	ROLLER	74-24-TKN	74-24-TRKN				
			STEEL DISC HI-CAP NEOPRENE	BALL	74-24-XKN-T-SD	74-24-XRKN-T-SD				
			375	POLYURETHANE / POLYOLEFIN HUB	BALL	74-24-XADI-M-PO				74-24-XRADI-M-PO
			400	HARD RUBBER	ACETAL	74-24-PH				74-24-PRH
				HARD RUBBER	ROLLER	74-24-TH				74-24-TRH
			600	ADVANCED ELASTOMER	PRECISION BALL	74-24-PXAE				74-24-PXRAE
	ADVANCED ELASTOMER	ROLLER		74-24-TAE	74-24-TRAЕ					
	CAST IRON	ROLLER		74-24-TCI	74-24-TRCI					
	1 1/2	185	EXTRA SOFT THERMO-PLASTIC RUBBER	DELRIN	74-24-DPD-M-PO-55	74-24-DRPD-M-PO-55	3-1/2			
			THERMO-PLASTIC RUBBER	ROLLER	74-24-TPD-M-PO-55	74-24-TRPD-M-PO-55				
		260	THERMO-PLASTIC RUBBER	DELRIN	74-24-DPD-M-PO	74-24-DRPD-M-PO				
			THERMO-PLASTIC RUBBER	ROLLER	74-24-TPD-M-PO	74-24-TRPD-M-PO				
		375	POLYOLEFIN	PLAIN	74-24-BPO	74-24-BRPO				
			POLYOLEFIN	ROLLER	74-24-TPO	74-24-TRPO				
		500	POLYURETHANE / POLYOLEFIN HUB	DELRIN	74-24-DADI-M-PO	74-24-DRADI-M-PO				
			POLYURETHANE / POLYOLEFIN HUB	ROLLER	74-24-TADI-M-PO	74-24-TRADI-M-PO				
600		PHENOLIC	ROLLER	74-24-TPR	74-24-TRPR					
		POLYURETHANE / CAST IRON HUB	ROLLER	74-24-TADI-M-CI	74-24-TRADI-M-CI					
5	1 1/4	300	STEEL DISC NEOPRENE	BALL	75-24-XDN-T-SD	75-24-XRDN-T-SD	5-1/2	6-7/16	3-7/8	
			STEEL DISC POLYURETHANE	BALL	75-24-XADI-T-SD	75-24-XRADI-T-SD				
	1 3/8	300	NEOPRENE RUBBER	ACETAL	75-24-PDN	75-24-PRDN	4			
			NEOPRENE RUBBER	ROLLER	75-24-TDN	75-24-TRDN				
			HI-CAP NEOPRENE	ACETAL	75-24-PKN	75-24-PRKN				
			HI-CAP NEOPRENE	ROLLER	75-24-TKN	75-24-TRKN				
			STEEL DISC HI-CAP NEOPRENE	BALL	75-24-XKN-T-SD	75-24-XRKN-T-SD				
			440	POLYURETHANE / POLYOLEFIN HUB	BALL	75-24-XADI-M-PO				75-24-XRADI-M-PO
			550	HARD RUBBER	ACETAL	75-24-PH				75-24-PRH
				HARD RUBBER	ROLLER	75-24-TH				75-24-TRH
	600	ADVANCED ELASTOMER	PRECISION BALL	75-24-PXAE	75-24-PXRAE					
		ADVANCED ELASTOMER	ROLLER	75-24-TAE	75-24-TRAЕ					
		POLYURETHANE / CAST IRON HUB	ROLLER	75-24-TADI-M-CI	75-24-TRADI-M-CI					
	1 1/2	190	EXTRA SOFT THERMO-PLASTIC RUBBER	DELRIN	75-24-DPD-M-PO-55	75-24-DRPD-M-PO-55	4			
			THERMO-PLASTIC RUBBER	ROLLER	75-24-TPD-M-PO-55	74-24-TRPD-M-PO-55				
		320	THERMO-PLASTIC RUBBER	DELRIN	75-24-DPD-M-PO	75-24-DRPD-M-PO				
			THERMO-PLASTIC RUBBER	ROLLER	75-24-TPD-M-PO	75-24-TRPD-M-PO				
		540	POLYOLEFIN	PLAIN	75-24-BPO	75-24-BRPO				
			POLYOLEFIN	ROLLER	75-24-TPO	75-24-TRPO				
		600	CAST IRON	ROLLER	75-24-TCI	75-24-TRCI				
PHENOLIC			ROLLER	75-24-TPR	75-24-TRPR					
600	POLYURETHANE / POLYOLEFIN HUB	DELRIN	75-24-DADI-M-PO	75-24-DRADI-M-PO						
	POLYURETHANE / POLYOLEFIN HUB	ROLLER	75-24-TADI-M-PO	75-24-TRADI-M-PO						
6	1 3/8	300	NEOPRENE RUBBER	ACETAL	76-24-PDN	76-24-PRDN	5	7-9/16	4-5/8	
			NEOPRENE RUBBER	ROLLER	76-24-TDN	76-24-TRDN				
		375	HI-CAP NEOPRENE	ACETAL	76-24-PKN	76-24-PRKN				
			HI-CAP NEOPRENE	ROLLER	76-24-TKN	76-24-TRKN				
		500	POLYURETHANE / POLYOLEFIN HUB	BALL	76-24-XADI-M-PO	76-24-XRADI-M-PO				
			POLYURETHANE / POLYOLEFIN HUB	ROLLER	76-24-TADI-M-PO	76-24-TRADI-M-PO				
		550	HARD RUBBER	ACETAL	76-24-PH	76-24-PRH				
			HARD RUBBER	ROLLER	76-24-TH	76-24-TRH				
	600	ADVANCED ELASTOMER	PRECISION BALL	76-24-PXAE	76-24-PXRAE					
		ADVANCED ELASTOMER	ROLLER	76-24-TAE	76-24-TRAЕ					
	1 1/2	225	EXTRA SOFT THERMO-PLASTIC RUBBER	DELRIN	76-24-DPD-M-PO-55	76-24-DRPD-M-PO-55	5			
			THERMO-PLASTIC RUBBER	ROLLER	76-24-TPD-M-PO-55	76-24-TRPD-M-PO-55				
		350	THERMO-PLASTIC RUBBER	DELRIN	76-24-DPD-M-PO	76-24-DRPD-M-PO				
			THERMO-PLASTIC RUBBER	ROLLER	76-24-TPD-M-PO	76-24-TRPD-M-PO				
		600	CAST IRON	ROLLER	76-24-TCI	76-24-TRCI				
			PHENOLIC	ROLLER	76-24-TPR	76-24-TRPR				
		600	POLYURETHANE / CAST IRON HUB	ROLLER	76-24-TADI-M-CI	76-24-TRADI-M-CI				
			POLYURETHANE / CAST IRON HUB	ROLLER	76-24-TADI-M-PO	76-24-TRADI-M-PO				
	700	POLYOLEFIN	ROLLER	76-24-TPO	76-24-TRPO					