

Load Capacity: 350 to 1,000 lbs.

# SERIES

## Heavy Duty Industrial

### Quality Features

- MACHINED CRAFTED SWIVEL RACEWAY.**  
 Upper main load bearing consisting of top plate and base plate are precisely machined by CNC lathe to close tolerances and dimensions. The upper set of 3/8" hardened steel ball bearings carries load weight, while lower set handles lateral thrust loads.
- EXTRA-STRONG CONTINUOUSLY WELDED SIDE LEGS.**  
 Yoke legs are formed from 1/4" thick steel and made wider to handle constant abuse from side thrust. Fork legs are continuously welded to yoke base for added strength and endurance.
- HEAT-TREATED MOVING PARTS.**  
 All moving parts are heat treated to a precise molecular depth and Rockwell hardness using a gas carburizing process that extends caster life under rugged conditions and shock loads.
- SEALED RACEWAYS WITH LUBE FITTING.**  
 Upper raceway is permanently assembled with a neoprene grease seal. Bottom raceway is covered with a metal grease seal cap that is press fit then secured with Epoxy. Pressure fitting is provided for lubrication using convention grease guns.



SWIVEL

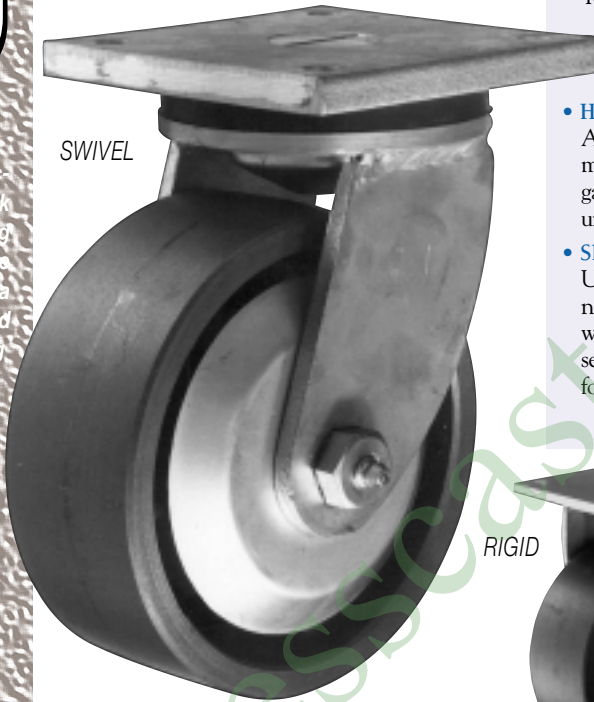

RIGID



### Options

- High-Temperature Wheels
- Conductive or Static-Dissipative Wheels
- Gray, Non-marking Wheels

Designed for heavy-duty service, construction features include 3/8" top plate, thick welded yoke, and a double ball bearing swivel raceway that is machined to close tolerances and exact dimensions. Both a neoprene seal and metal dust cap are used to prevent foreign matter from obstructing the swivel raceway. Pressure lubrication fittings are provided in both the swivel fork and the wheel axle bolt.

Used in heavy-duty applications such as:

- Heavy Machinery
- Die Setting Tables
- Computer Mainframes
- Air Cargo Dollies
- Cranes and Gantries
- Electric Pallet Lifts

The 20 series is specifically designed to be the most heavily constructed caster of its kind. Standard finish is bright zinc.

### DOUBLE BALL BEARING SWIVEL RACEWAY 20 SERIES

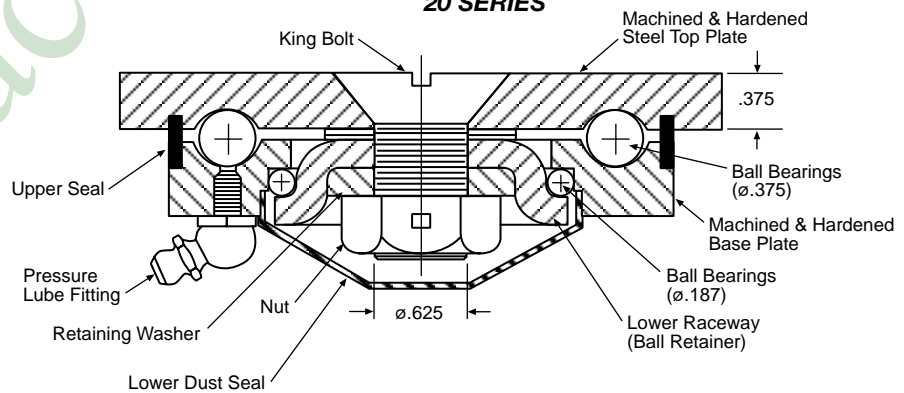

### Wheel Selection

ADVANCED ELASTOMER

NEOPRENE RUBBER

HI-CAP NEOPRENE

THERMO PLASTIC RUBBER

CAST IRON HUB

MOLD-ON POLYURETHANE

PAGE 106



PAGE 108



PAGE 110



PAGE 122



PAGE 128





## TOP PLATE

STANDARD

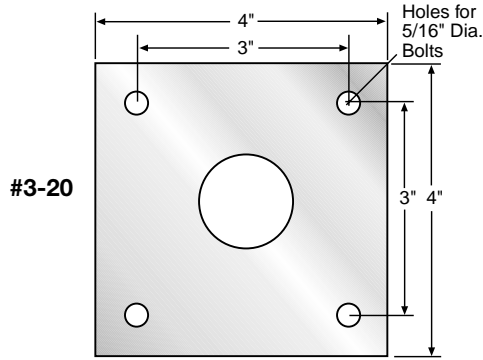

Heavy Duty Industrial

Diameter	Tread Width	Load Capacity	Wheel Material	Bearing	Swivel Part Number	Rigid Part Number	Approx. Weight	Overall Height	Swivel Radius		
3	1 7/8	350	NEOPRENE RUBBER	ROLLER	23-3-TDN	23-3-TRDN	5-1/2	4-1/2	2-1/2		
		440	HI-CAP NEOPRENE	ROLLER	23-3-TKN	23-3-TRKN					
		800	HARD RUBBER	ROLLER	23-3-TH	23-3-TRH					
		1000	POLYURETHANE / CAST IRON HUB	ROLLER	23-3-TADI-M-CI	23-3-TRADI-M-CI					
	2	1000	CAST IRON	ROLLER	23-3-TCI	23-3-TRCI	7				
		1000	PHENOLIC	ROLLER	23-3-TPR	23-3-TRPR	5-1/2				
		4	1 7/8	350	NEOPRENE RUBBER	ROLLER	24-3-TDN			24-3-TRDN	6
				440	HI-CAP NEOPRENE	ROLLER	24-3-TKN			24-3-TRKN	
800	HARD RUBBER			ROLLER	24-3-TH	24-3-TRH					
1000	POLYURETHANE / CAST IRON HUB			ROLLER	24-3-TADI-M-CI	24-3-TRADI-M-CI	8-1/4				
2	200		EXTRA SOFT THERMO-PLASTIC RUBBER	DELRIN	24-3-DPD-M-PO-55	24-3-DRPD-M-PO-55	4-1/2				
	300		THERMO-PLASTIC RUBBER	ROLLER	24-3-TPD-M-PO-55	24-3-TRPD-M-PO-55					
	600		POLYURETHANE / POLYOLEFIN HUB	DELRIN	24-3-DADI-M-PO	24-3-DRADI-M-PO					
	700		POLYOLEFIN	ROLLER	24-3-TPO	24-3-TRPO					
5	1 7/8	350	NEOPRENE RUBBER	ROLLER	25-3-TDN	25-3-TRDN	7-1/2				
		440	HI-CAP NEOPRENE	ROLLER	25-3-TKN	25-3-TRKN					
		800	HARD RUBBER	ROLLER	25-3-TH	25-3-TRH					
		1000	POLYURETHANE / CAST IRON HUB	ROLLER	25-3-TADI-M-CI	25-3-TRADI-M-CI	10				
	2	225	EXTRA SOFT THERMO-PLASTIC RUBBER	DELRIN	25-3-DPD-M-PO-55	25-3-DRPD-M-PO-55		5			
		350	THERMO-PLASTIC RUBBER	ROLLER	25-3-TPD-M-PO-55	25-3-TRPD-M-PO-55					
		800	POLYOLEFIN	ROLLER	25-3-TPO	25-3-TRPO					
		850	POLYURETHANE / CAST IRON HUB	TAPERED ROLLER	25-3-YADI-M-CI	25-3-YRADI-M-CI	10				
1000	POLYURETHANE / POLYOLEFIN HUB	DELRIN	25-3-DADI-M-PO	25-3-DRADI-M-PO	5						
1000	PHENOLIC	ROLLER	25-3-TPR	25-3-TRPR	7-1/2						
1000	POLYURETHANE / POLYOLEFIN HUB	ROLLER	25-3-TADI-M-PO	25-3-TRADI-M-PO	5						

POLYOLEFIN HUB

POLYURETHANE

PAGE 126

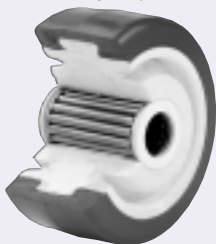

PHENOLIC

PAGE 134

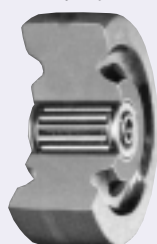

POLYOLEFIN

PAGE 136



CAST IRON

PAGE 138

