

LPA/LKPA 12-Series Medium Duty Institutional Top Plate Swivel Casters

220 - 330 lbs ✓RoHS

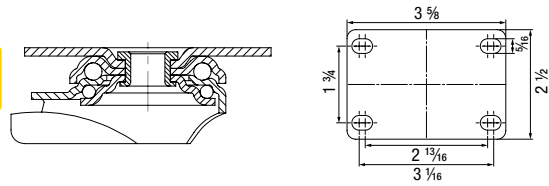

LKPXA 12-Series Medium Duty Stainless Steel Institutional Top Plate Swivel Casters

220 - 265 lbs ✓RoHS

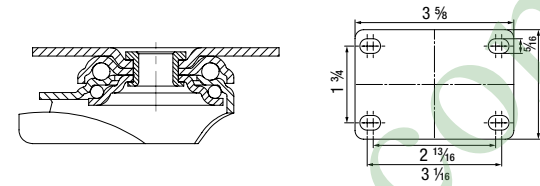

- VSTH** Tread: High-quality polyurethane-elastomer Blickle Extrathane®, 92° shore A, light brown, non-marking, non-staining. Cast tread. Wheel center: Made of steel. Bearing type: Ball bearing. For more information refer to page 82
- TPA** Tread: High-quality thermoplastic rubber-elastomer (TPE), containing traces of oil, 85° shore A, gray, non-marking, chemically bonded. Wheel center: Impact-resistant polypropylene, silver gray. Bearing types: Plain bore or ball bearing (C) with synthetic thread guard. For more information refer to page 77

- POA** Wheel: Impact-resistant nylon, 70° shore D, black. Bearing type: Plain bore. For more information refer to page 88
- PATH** Tread: High-quality thermoplastic polyurethane (TPU), 94° shore A, dark gray, non-marking, non-staining, chemically bonded. Wheel center: Impact-resistant nylon, silver gray. Bearing type: Ball bearing (C) with synthetic thread guard. For more information refer to page 78

- TPA** Tread: High-quality thermoplastic rubber-elastomer (TPE), containing traces of oil, 85° shore A, gray, non-marking, chemically bonded. Wheel center: Impact-resistant polypropylene, silver gray. Bearing type: **Plain bore**. For more information refer to page 77
- TPA** Tread: High-quality thermoplastic rubber-elastomer (TPE), containing traces of oil, 85° shore A, gray, non-marking, chemically bonded. Wheel center: Impact-resistant polypropylene, silver gray. Bearing type: **Ball bearing (C)** with synthetic thread guard and additional ball bearing seals. For more information refer to page 77

- PO** Wheel: Impact-resistant nylon, 70° shore D, natural white. Bearing type: Plain bore. For more information refer to page 88
- PATH** Tread: High-quality thermoplastic polyurethane (TPU), 94° shore A, dark gray, non-marking, non-staining, chemically bonded. Wheel center: Impact-resistant nylon, silver gray. Bearing type: Ball bearing (C) with synthetic thread guard and additional ball bearing seals. For more information refer to page 78

Swivel Casters	Swivel Casters with 'Stop-Fix' Brake *	Wheel Ø [inch] [mm]	Wheel Width [inch] [mm]	Load Capacity [lbs] [kg]	Bearing Type	Total Height [inch] [mm]	Plate Size [inch]	Bolt Hole Spacing [inch]	For Mounting Bolt [inch]	Swivel Lead [inch]
LPA-/LKPA-VSTH Series										
LPA-VSTH 35K **		1 3/8 [35]	1 1/8 [27]	220 [100]	Ball bearing	2 1/2 [52]	2 1/2 x 2 1/2	1 1/2 x 1 1/2 - 1 5/8 x 1 5/8	3/8	5/8
LKPA-VSTH 50K-12		2 [50]	1 1/4 [33]	330 [150]	Ball bearing	2 3/8 [73]	2 1/2 x 3 3/8	1 3/4 x 2 1/8 - 3 1/8	5/8	1 1/8
LKPA-TPA Series										
LKPA-TPA 80G-12	LKPA-TPA 80G-12-FI	3 3/8 [80]	1 1/4 [32]	220 [100]	Plain bore	4 3/8 [111]	2 1/2 x 3 3/8	1 3/4 x 2 1/8 - 3 1/8	5/8	1 1/8
LKPA-TPA 80K-12-FK	LKPA-TPA 80K-12-FI-FK	3 3/8 [80]	1 1/4 [32]	220 [100]	Ball bearing (C)	4 3/8 [111]	2 1/2 x 3 3/8	1 3/4 x 2 1/8 - 3 1/8	5/8	1 1/8
LKPA-TPA 101G-12	LKPA-TPA 101G-12-FI	4 [100]	1 1/4 [32]	245 [110]	Plain bore	5 3/8 [136]	2 1/2 x 3 3/8	1 3/4 x 2 1/8 - 3 1/8	5/8	1 1/8
LKPA-TPA 101K-12-FK	LKPA-TPA 101K-12-FI-FK	4 [100]	1 1/4 [32]	245 [110]	Ball bearing (C)	5 3/8 [136]	2 1/2 x 3 3/8	1 3/4 x 2 1/8 - 3 1/8	5/8	1 1/8
LKPA-TPA 126G-12	LKPA-TPA 126G-12-FI	5 [125]	1 1/4 [32]	265 [120]	Plain bore	6 3/8 [161]	2 1/2 x 3 3/8	1 3/4 x 2 1/8 - 3 1/8	5/8	1 1/8
LKPA-TPA 126K-12-FK	LKPA-TPA 126K-12-FI-FK	5 [125]	1 1/4 [32]	265 [120]	Ball bearing (C)	6 3/8 [161]	2 1/2 x 3 3/8	1 3/4 x 2 1/8 - 3 1/8	5/8	1 1/8
LKPA-POA Series										
LKPA-POA 80G-12	LKPA-POA 80G-12-FI	3 3/8 [80]	1 1/4 [32]	265 [120]	Plain bore	4 3/8 [111]	2 1/2 x 3 3/8	1 3/4 x 2 1/8 - 3 1/8	5/8	1 1/8
LKPA-POA 100G-12	LKPA-POA 100G-12-FI	4 [100]	1 1/4 [32]	265 [120]	Plain bore	5 3/8 [136]	2 1/2 x 3 3/8	1 3/4 x 2 1/8 - 3 1/8	5/8	1 1/8
LKPA-POA 125G-12	LKPA-POA 125G-12-FI	5 [125]	1 1/4 [32]	265 [120]	Plain bore	6 3/8 [161]	2 1/2 x 3 3/8	1 3/4 x 2 1/8 - 3 1/8	5/8	1 1/8
LKPA-PATH Series										
LKPA-PATH 80K-12-FK	LKPA-PATH 80K-12-FI-FK	3 3/8 [80]	1 1/4 [32]	265 [120]	Ball bearing (C)	4 3/8 [111]	2 1/2 x 3 3/8	1 3/4 x 2 1/8 - 3 1/8	5/8	1 1/8
LKPA-PATH 101K-12-FK	LKPA-PATH 101K-12-FI-FK	4 [100]	1 1/4 [32]	265 [120]	Ball bearing (C)	5 3/8 [136]	2 1/2 x 3 3/8	1 3/4 x 2 1/8 - 3 1/8	5/8	1 1/8
LKPA-PATH 126K-12-FK	LKPA-PATH 126K-12-FI-FK	5 [125]	1 1/4 [32]	265 [120]	Ball bearing (C)	6 3/8 [161]	2 1/2 x 3 3/8	1 3/4 x 2 1/8 - 3 1/8	5/8	1 1/8

* Brake lever made of steel
** With top plate no. 22

	Rigid Casters	Electrically Conductive Version, Non-Marking Gray ***	Electrically Conductive Version, Non-Marking Gray ***	Special Colors (Electrostatic Powder Coating)	Blue Rubber Wheel (POEV Series)	European Metric Top Plate Fitting	More Options with this Bolt Hole Pattern
Product Code Suffix	BKPA series	-ELS	-ELS		LKPA-POEV series		
Available for	Consult factory	TPA series Consult factory	PATH series Consult factory	Consult factory	Consult factory	Consult factory	Refer to page 48/49

*** Load capacity of the wheel is reduced by 35 % to guarantee conductivity.

Swivel Casters	Swivel Casters with 'Stop-Fix' Brake *	Wheel Ø [inch] [mm]	Wheel Width [inch] [mm]	Load Capacity [lbs] [kg]	Bearing Type	Total Height [inch] [mm]	Plate Size [inch]	Bolt Hole Spacing [inch]	For Mounting Bolt [inch]	Swivel Lead [inch]
LKPXA-TPA Series (plain bore)										
LKPXA-TPA 80G-12	LKPXA-TPA 80G-12-FI	3 3/8 [80]	1 1/4 [32]	220 [100]	Plain bore	4 3/8 [111]	2 1/2 x 3 3/8	1 3/4 x 2 1/8 - 3 1/8	5/8	1 1/8
LKPXA-TPA 101G-12	LKPXA-TPA 101G-12-FI	4 [100]	1 1/4 [32]	245 [110]	Plain bore	5 3/8 [136]	2 1/2 x 3 3/8	1 3/4 x 2 1/8 - 3 1/8	5/8	1 1/8
LKPXA-TPA 126G-12	LKPXA-TPA 126G-12-FI	5 [125]	1 1/4 [32]	265 [120]	Plain bore	6 3/8 [161]	2 1/2 x 3 3/8	1 3/4 x 2 1/8 - 3 1/8	5/8	1 1/8
LKPXA-TPA Series (ball bearing)										
LKPXA-TPA 80K-12-FK	LKPXA-TPA 80K-12-FI-FK	3 3/8 [80]	1 1/4 [32]	220 [100]	Ball bearing (C)	4 3/8 [111]	2 1/2 x 3 3/8	1 3/4 x 2 1/8 - 3 1/8	5/8	1 1/8
LKPXA-TPA 101K-12-FK	LKPXA-TPA 101K-12-FI-FK	4 [100]	1 1/4 [32]	245 [110]	Ball bearing (C)	5 3/8 [136]	2 1/2 x 3 3/8	1 3/4 x 2 1/8 - 3 1/8	5/8	1 1/8
LKPXA-TPA 126K-12-FK	LKPXA-TPA 126K-12-FI-FK	5 [125]	1 1/4 [32]	265 [120]	Ball bearing (C)	6 3/8 [161]	2 1/2 x 3 3/8	1 3/4 x 2 1/8 - 3 1/8	5/8	1 1/8
LKPXA-PO Series										
LKPXA-PO 80G-12	LKPXA-PO 80G-12-FI	3 3/8 [80]	1 1/4 [32]	265 [120]	Plain bore	4 3/8 [111]	2 1/2 x 3 3/8	1 3/4 x 2 1/8 - 3 1/8	5/8	1 1/8
LKPXA-PO 101G-12	LKPXA-PO 101G-12-FI	4 [100]	1 1/4 [32]	265 [120]	Plain bore	5 3/8 [136]	2 1/2 x 3 3/8	1 3/4 x 2 1/8 - 3 1/8	5/8	1 1/8
LKPXA-PO 126G-12	LKPXA-PO 126G-12-FI	5 [125]	1 1/4 [32]	265 [120]	Plain bore	6 3/8 [161]	2 1/2 x 3 3/8	1 3/4 x 2 1/8 - 3 1/8	5/8	1 1/8
LKPXA-PATH Series										
LKPXA-PATH 80K-12-FK	LKPXA-PATH 80K-12-FI-FK	3 3/8 [80]	1 1/4 [32]	265 [120]	Ball bearing (C)	4 3/8 [111]	2 1/2 x 3 3/8	1 3/4 x 2 1/8 - 3 1/8	5/8	1 1/8
LKPXA-PATH 101K-12-FK	LKPXA-PATH 101K-12-FI-FK	4 [100]	1 1/4 [32]	265 [120]	Ball bearing (C)	5 3/8 [136]	2 1/2 x 3 3/8	1 3/4 x 2 1/8 - 3 1/8	5/8	1 1/8
LKPXA-PATH 126K-12-FK	LKPXA-PATH 126K-12-FI-FK	5 [125]	1 1/4 [32]	265 [120]	Ball bearing (C)	6 3/8 [161]	2 1/2 x 3 3/8	1 3/4 x 2 1/8 - 3 1/8	5/8	1 1/8

* Brake lever made of nylon

	Rigid Casters	Electrically Conductive Version, Non-Marking Gray **	Electrically Conductive Version, Non-Marking Gray **	Heat-Resistant Version	European Metric Top Plate Fitting
Product Code Suffix	BKPA series	-ELS	-ELS		
Available for	Consult factory	TPA series Consult factory	PATH series Consult factory	Refer to page 64	Consult factory

** Load capacity of the wheel is reduced by 35 % to guarantee conductivity.