

## LI 12-Series Medium Duty Heat-Resistant Industrial Top Plate Casters

220 - 330 lbs    -15° F - +480° F    ✓RoHS

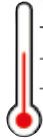

## LIKPXA 12-Series Medium Duty Heat-Resistant Stainless Steel Institutional Top Plate Swivel Casters

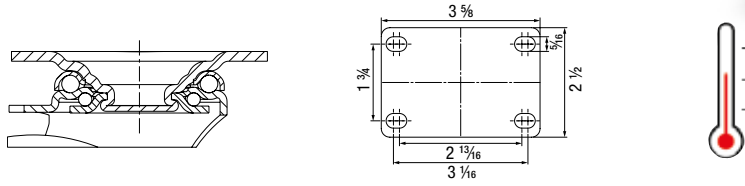

260 lbs    -15° F - +480° F    ✓RoHS

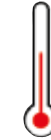
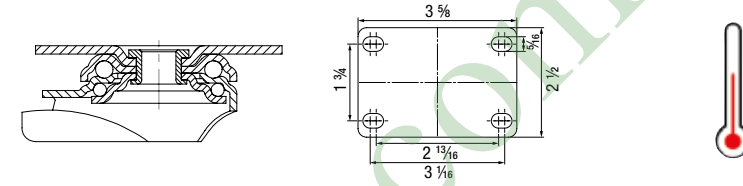

**POSI**       Tread: Highly heat-resistant silicone rubber Blickle TempLine® Comfort, 75° shore A, black, **non-marking**. Vulcanized tire.  
Wheel center: Impact and heat-resistant, glass-filled nylon, gray.  
Bearing type: Plain bore with teflon-coated stainless steel spanners.  
For more information refer to page 93



**POHI**       Wheel: High-quality, impact and heat-resistant, glass-filled nylon Blickle TempLine® Performance, 85° shore D, gray.  
Bearing type: Plain bore with teflon-coated stainless steel spanners.  
For more information refer to page 94



**POH**       Wheel: High-quality, impact and heat-resistant, glass-filled nylon Blickle TempLine® PerformanceLight, 85° shore D, natural color. -15° F to +340° F.  
Bearing type: Plain bore.  
For more information refer to page 94



**POHI**       Wheel: High-quality, impact and heat-resistant, glass-filled nylon Blickle TempLine® Performance, 85° shore D, gray. -15° F to +480° F.  
Bearing type: Plain bore.  
For more information refer to page 94



Swivel Casters	Rigid Casters	Swivel Casters with 'Stop-Fix' Brake	Wheel Ø [inch][mm]	Wheel Width [inch][mm]	Load Capacity [lbs] [kg]	Bearing Type	Total Height [inch] [mm]	Plate Size [inch]	Bolt Hole Spacing [inch]	For Mounting Bolt [inch]	Swivel Lead [inch]
<b>LI-POSI Series</b>											
LI-POSI 100G-12-XAT	B-POSI 100G-12-XAT	LI-POSI 100G-12-FI-XAT	4 [100]	1 1/8 [30]	220 [100]	Plain bore	5 1/8 [130]	2 1/2 x 3 3/8	1 3/4 x 2 13/16 - 3 1/8	5/16	1 1/16
LI-POSI 125G-12-XAT	B-POSI 125G-12-XAT	LI-POSI 125G-12-FI-XAT	5 [125]	1 1/8 [40]	265 [120]	Plain bore	6 1/8 [155]	2 1/2 x 3 3/8	1 3/4 x 2 13/16 - 3 1/8	5/16	1 1/16
<b>LI-POHI Series</b>											
LI-POHI 100G-12-XAT	B-POHI 100G-12-XAT	LI-POHI 100G-12-FI-XAT	4 [100]	1 1/8 [30]	330 [150]	Plain bore	5 1/8 [130]	2 1/2 x 3 3/8	1 3/4 x 2 13/16 - 3 1/8	5/16	1 1/16
LI-POHI 125G-12-XAT	B-POHI 125G-12-XAT	LI-POHI 125G-12-FI-XAT	5 [125]	1 1/8 [40]	330 [150]	Plain bore	6 1/8 [155]	2 1/2 x 3 3/8	1 3/4 x 2 13/16 - 3 1/8	5/16	1 1/16

All casters include high-temperature grease.

Includes teflon-coated stainless steel spanners (XAT)



Options	With Non-Marking Gray Rubber Tire *	With Ball Bearings Lubricated with Special Heat-Resistant Grease	With Silicone Rubber Tread and Aluminum Wheel Center	With Bigger Wheel Diameters	With Hollow Kingpin, for Mounting Bolt Ø 1/2"	Heat-Resistant Heavy Duty Casters up to 2,750 lbs	European Metric Top Plate Fitting
<b>Product Code Suffix</b>	-SG	-HK	LI-ALSI series	LI-POHI series	LIR series		
Available for	POSI series Consult factory	POHI series Consult factory	Consult factory	Consult factory	Consult factory	Consult factory	Consult factory

\* Operating temperature up to +465° F

Swivel Casters	Swivel Casters with 'Stop-Fix' Brake *	Wheel Ø [inch] [mm]	Wheel Width [inch] [mm]	Load Capacity [lbs] [kg]	Bearing Type	Total Height [inch] [mm]	Plate Size [inch]	Bolt Hole Spacing [inch]	For Mounting Bolt [inch]	Swivel Lead [inch]
<b>LIKPXA-POH Series (up to +340° F)</b>										
LIKPXA-POH 100G-12	LIKPXA-POH 100G-12-FI	4 [100]	1 1/8 [30]	260 [120]	Plain bore	5 3/8 [136]	2 1/2 x 3 3/8	1 3/4 x 2 13/16 - 3 1/8	5/16	1 1/16
LIKPXA-POH 125G-12	LIKPXA-POH 125G-12-FI	5 [125]	1 1/8 [30]	260 [120]	Plain bore	6 3/8 [161]	2 1/2 x 3 3/8	1 3/4 x 2 13/16 - 3 1/8	5/16	1 1/16
<b>LIKPXA-POHI Series (up to +480° F)</b>										
LIKPXA-POHI 100G-12	LIKPXA-POHI 100G-12-FI	4 [100]	1 1/8 [30]	260 [120]	Plain bore	5 3/8 [136]	2 1/2 x 3 3/8	1 3/4 x 2 13/16 - 3 1/8	5/16	1 1/16
LIKPXA-POHI 125G-12	LIKPXA-POHI 125G-12-FI	5 [125]	1 1/8 [30]	260 [120]	Plain bore	6 3/8 [161]	2 1/2 x 3 3/8	1 3/4 x 2 13/16 - 3 1/8	5/16	1 1/16

\* Brake lever made of stainless steel  
All casters include high-temperature grease.

Options	Rigid Casters with POHI Wheels in Gray Color	Rigid Casters with POH Wheels in Natural Color	Teflon-Coated Stainless Steel Spanners	European Metric Top Plate Fitting
<b>Product Code Suffix</b>	BKPXA-POHI series	BKPXA-POH series	XAT series	
Available for	Consult factory	Consult factory	Consult factory	Consult factory